

INSTALLATION & OPERATING INSTRUCTIONS

HONEYCOMB SHADES

Cordless Lift & Lock

Thank you for your purchase. This shade has been custom built for you from the highest quality materials. To avoid errors and save valuable time, please read these instructions before installing your new shades.

TOOLS YOU WILL NEED

1. Pencil or Marker
2. Measuring Tape
3. Phillips Screwdriver
4. Carpenter's Level
5. Power Drill
6. Mounting Fasteners
7. 3/32" Drill Bit & 1/4" Hex Nut Driver Bit

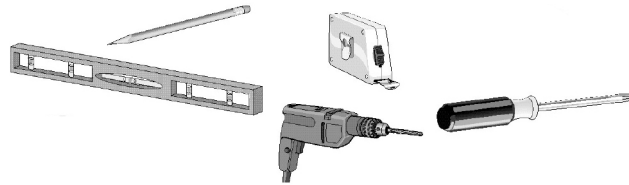



Mounting Surface	Fastener
Drywall, Plaster	Wall Anchors, Expansion Bolts (Not provided) 
Metal	Sheet Metal Screws (Not provided) 
Wood	No. 6 Hex Head Screws (Provided) 

TABLE OF CONTENTS

Getting Started	Page 2
Mounting Type	Page 2
Bracket Installation	Page 2
Inside Mount	Page 3
Outside Mount	Page 3
Side Mount	Page 3
Installing the Shade	Page 4
Operating the Shade	Page 4
Adjusting the Shade	Page 4-5
Care and Cleaning	Page 5
Warranty Information	Page 6

GETTING STARTED

All of the required installation components are wrapped in your package along with these instructions. Check that the parts you have correspond to the parts shown below.

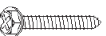
NOTE: Some parts may vary depending upon your chosen mounting options.

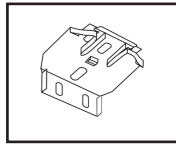

Installation Brackets

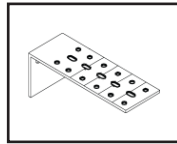

Extension Bracket
(optional)

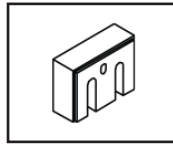

Spacer Blocks
(optional)

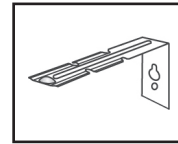

Side Mount Bracket
(optional)

Mounting Types

If the installation brackets are mounted correctly, the rest of the installation process will follow easily. To prepare for this important first step, review the mounting types and basic window terminology illustrated below.

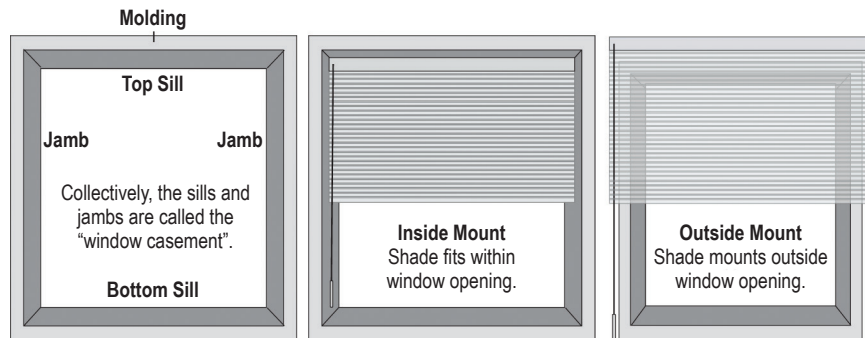

Bracket Installation

Installation brackets may be used for **INSIDE** or **OUTSIDE** mounts.

Mounting the brackets level is essential for proper operation of the shade. Shim the brackets if necessary to achieve a level alignment.

The bracket requirements and placements are the same for inside and outside mounts. Refer to the following spacing diagram and bracket requirement chart.

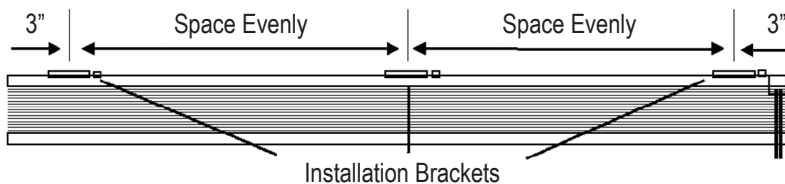

Installation Bracket Requirement Chart	
Shade Width	Brackets Required
12" to 31"	2
31-1/8" to 72"	3
72-1/8" to 84"	4

Inside Mount

For inside mounts the installation brackets will be screwed in place through the top two holes of each bracket.

Refer to the depth requirements chart:

NOTE: Prior to mounting the brackets, add any clearance depth required to avoid obstructions such as window cranks or handles.

Minimum Depth	Fully Recessed
1"	2-1/2"

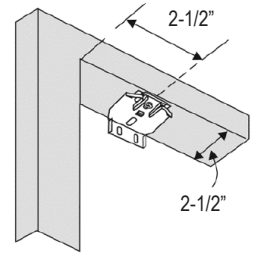

ATTACH THE BRACKETS

1. Screw the bracket through top two holes to desired window sill location.
 - Use a 3/32" drill bit to drill holes for the screws.
2. Ensure all brackets are level and aligned.

IMPORTANT: If you are fastening the installation brackets to drywall, be sure to use wall anchors and follow the instructions provided with the anchors. (Anchors not provided.)

Outside Mount

For outside mounts the installation brackets will be screwed in place through the two back holes of each bracket. Refer to the minimum surface height chart.

ATTACH THE BRACKETS

1. Screw the bracket through back two holes to desired location.
 - Use a 3/32" drill bit to drill holes for the screws.
2. Ensure all brackets are level and aligned.

IMPORTANT: If you are fastening the installation brackets to drywall, be sure to use wall anchors and follow the instructions provided with the anchors. (Anchors not provided.)

Minimum Height
3/4"

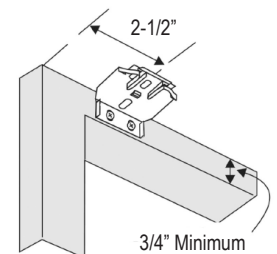

SPACER BLOCKS (optional)

1. Spacer blocks will be attached to the end of each bracket.
2. Ensure the screws are long enough to secure brackets to surface.
3. Do not use more than three spacer blocks per bracket.
4. If installing extension brackets, do not use spacer blocks.

EXTENSION BRACKETS (optional)

1. Position the extension brackets to the desired wall location.
2. The bracket tops must be aligned and level to one another.
3. Mount the extension brackets through the back holes with two screws.
4. Attach the installation brackets to the extension brackets.

Installation brackets attached to extension brackets with the included screws and nuts.

Use the same holes for all brackets to ensure even projection from the surface.

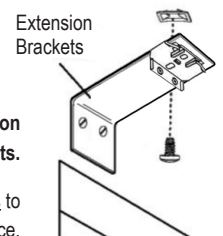

Side Mount

1. Align the bracket top with the desired height of the top of the head rail. Mark holes for screws, remove brackets and drill holes.
2. Insert screws for keyhole slots only. Approximately 1/8" of the screw should be left protruding.
3. Pull the end cap out of the headrail and slide the bracket on as shown. Replace the end cap and then slide the bracket all the way into the headrail.

Install the second bracket in the same manner as the first bracket.

Hook one bracket onto the screw in the window frame, using the keyhole slot. Bring the other end bracket over the screw at the other side of the frame. Slide down, flexing bracket inward until the screw engages in the keyhole slot.

Make sure both brackets are slipped down all the way in the keyhole slot so that the screw is in the top portion of the keyhole slot. Install a screw in the bottom hole of each bracket. Tighten all screws.

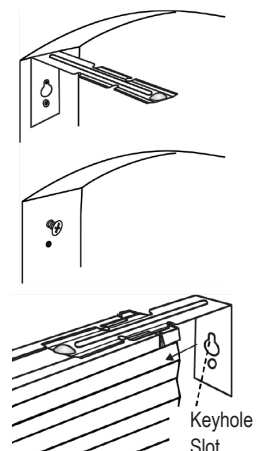

Installing the Shade

MOUNT THE HEADRAIL

1. Hold the shade up near the brackets and insert the front clip of the bracket into the front groove of the rail.
2. Make sure the shade is centered in the window opening.
3. Push the rail back and up until the back clips of the bracket are inserted in the back of the rail.

To **REMOVE** shade, reverse procedure. As you release the brackets, support the head rail to keep it from falling.

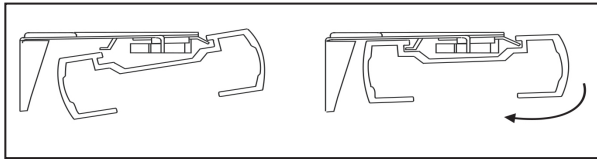

Installing the Shade

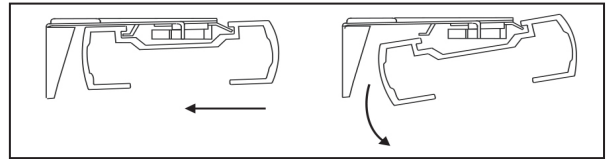

Removing the Shade

Operating the Shade

TO RAISE AND LOWER THE CORDLESS LIFT & LOCK SHADE

1. Push and hold the **button** on the bottomrail handle.
2. Raise or lower the shade to the desired position.
3. Release the button to lock the shade into place.



Adjusting the Shade

1. Raise and lower the shade several times.
2. If the length is incorrect or the bottom rail is not level, use the following steps to correct.

BOTTOM-UP BOTTOMRAIL AND TOP-DOWN/BOTTOM-UP

INTERMEDIATE RAIL SHADE ADJUSTMENT

1. Lift bottomrail on the side to be adjusted. This will take the weight off the cord.
2. Use a screwdriver or dime.
 - Turn screw clockwise to lift that side of the shade.
 - Turn screw counter clockwise to lower that side of the shade.
 - Half a revolution is 1/4" adjustment (maximum adjustment is 1/2").

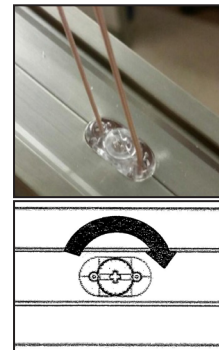

Adjusting the Shade

TOP-DOWN/BOTTOM-UP BOTTOMRAIL SHADE ADJUSTMENT

1. Remove right end cap of the bottomrail
2. Remove the small, white plastic tool located inside the bottomrail
3. Find the plastic dial just to the right of where the tool was positioned
 - Using the tool to depress the dial about 1/4"
 - Turn clockwise to lower the bottomrail
 - Turn counterclockwise to raise raise the bottomrail
 - When shade has been adjusted to the desired level remove the tool from the dial and insert it back into the bottomrail
4. Replace end cap.

NOTE: *If the tool gets misplaced a flathead screwdriver may be used.*



CARE AND CLEANING

Honeycomb shades are made of an anti-static, dust resistant fabric which repels dirt and dust. For most of these fabrics, the following options are available if your shade needs cleaning.

DUSTING: Regular light dusting with a feather duster is all the cleaning that is needed in most circumstances.

VACUUMING: Use a hand-held vacuum with low suction for more thorough dust removal.

SPOT CLEANING: Use the following steps for spot cleaning: (1) Prepare a solution of warm water and mild dishwashing detergent. (2) Dampen a clean cloth in the solution and ring it out. (3) Dab the spot with the dampened cloth until it is gone. **DO NOT RUB THE FABRIC.** (4) Allow the shade to dry in the completely lowered position.

CAUTION: *Avoid creasing Blackout fabrics during cleaning.*

DEEP CLEANING: Use the following steps for deep cleaning: (1) Immerse shade in basin or bathtub filled with warm water and mild detergent. (2) Rinse with clean water. (3) Fully raise shade and tilt to eliminate excess water, (4) Reinstall damp shade, lower it, and let it dry completely.

CAUTION: Do not immerse Blackout fabrics. Do not immerse Cordless Lift & Lock bottomrail in water.

ULTRASONIC CLEANING: Standard shades, except those made with Blackout or Blackout Lining, can be ultrasonically cleaned by a professional.

- Specify that a mild detergent be used.
- Never immerse the headrail in the solution.
- Dry the shade completely in the lowered position.

CAUTION: *Do not ultrasonically clean Blackout fabrics. Do not immerse headrail in water.*

WARRANTY INFORMATION

Lifetime Limited Warranty covering our Custom Made Blinds

We extend this lifetime limited warranty to the original purchaser. This warranty applies only to manually operated Custom Products properly installed in the window, door or interior area for which they were intended. Installation of the product must be in accordance with accompanying instructions. The product cannot be modified. It is the purchaser's responsibility to maintain and clean the product in compliance with the instruction provided. The product must be used only in the window for which it was purchased. Damage to the product resulting from misuse, abuse, direct exposure to salty air or discoloration due to sunlight or the passage of time is not covered by this warranty.

This warranty does not apply to conditions caused by normal wear and tear upon the product. This warranty is exclusive and in lieu of all other obligations, liabilities or warranties. In no event shall the Manufacturer be liable for incidental or consequential damages or for any other direct or indirect damage, loss, cost, expense or fee. Some states do not allow the exclusion or limitation of incidental or consequential damages, so this exclusion or limitation may not apply to you.

In the event of a defect under this warranty, we will repair or replace the product, at our option, provided it is returned to our store. Our warranty obligation excludes shipping charges and labor costs for measuring and installation. Repairs will be made with like or similar parts. This warranty gives you specific legal rights, and you may have other rights which vary from state to state.

Notes: Motorization Systems are warranted for five years from the date of purchase. Specialty Blinds and Shades are warranted for one year from the date of purchase.

This warranty does not apply to Commercial Orders.

