

PRISTINE

ESSENTIALS • SIGNATURE • LUX
ROLLER SHADES



Photograph courtesy of Phifer



Proudly made in the USA

**PORTER
PRESTON**

Quality Wholesale Window Coverings

Contract • Hospitality • Healthcare • Residential

www.porterpreston.com

203-753-1113

customerservice@porterpreston.com

TABLE OF CONTENTS

PRISTINE MSRP PRICE GRIDS

Fabric Specifications.....1-3
 Fabric Price Grids 1-8.....4-6
 Components Price Grid 9.....7
 Somfy Price Grid 10.....8-11
 Automate Price Grid 11.....12

PRISTINE MEASURING & ORDERING

Measuring.....13
 Production Details.....14
 Chainhold Tension Device.....15
 Skyline.....16
 Galaxy & Spring Assist.....17
 Opulence Brackets.....18
 Chain Options.....19
 Cordless Easy Spring Air.....20
 Spring Roller Shades.....21
 Hem Bar Options.....22
 Valance Options.....23
 Curved Cassette 100 & 11024
 Pocket Contract.....26-27
 Hanger-Contract.....28
 Side & Sill Channels.....29
 Roller Shade Material.....30

MOTORIZED EXTERIOR SCREENS.....31
WARRANTY.....32



FABRICS	Price Grid	% Openness	Max Fabric Width	Railroad	Weight oz/sq yd	Thickness	Commercial Fire Rating NFPA 701	MA H4900 Compliant/ Antimony Free	Green Guard Gold	Fungal Resistance ASTM G21
ICF Duplex 0%	1	0%	72"	Y	12.50	0.013	Y	Y	Y	Y
ICF Linen Glass 0%	1	0%	72"	Y	11.30	0.014	Y	Y	Y	Y
ICF Moire 0%	1	0%	72"	Y	12.00	0.014	Y	Y	Y	Y
ICF NLFG 0%	1	0%	72"	Y	13.60	0.013	Y	Y	Y	Y
ICF Opaque 0%	1	0%	72"	Y	12.50	0.013	Y	Y	Y	Y
ICF TFR <1%	1	<1%	72"	N	6.40	0.010	Y	Y	Y	Y
ICF Translucent Plus <1%	1	<1%	72"	Y	9.70	0.009	Y	Y	Y	Y
ICF Vision Plus 0% *	3	0%	98"	Y	17.90	0.023	Y	Y	Y	Y
ICF Wide Shade 0%	4	0%	120"	Y	17.50	0.017	Y	Y	Y	Y
Mermet E Screen 0.5% *	6	0.5%	122"	Y	13.54	0.023	Y	Y	Y	Y
Mermet E Screen 1% *	6	1%	122"	Y	13.30	0.020	Y	Y*	Y	Y
Mermet E Screen 3%	6	3%	122"	Y	11.60	0.017	Y	Y*	Y	Y
Mermet E Screen 5%	5	5%	122"	Y	10.70	0.016	Y	Y*	Y	Y
Mermet E Screen 10%	5	10%	122"	Y	10.30	0.020	Y	Y*	Y	Y
Mermet E Screen Deco 1% *	6	1%	122"	Y	12.30	0.022	Y	Y*	Y	Y
Mermet E Screen Deco 3%	6	3%	122"	Y	11.50	0.019	Y	Y*	Y	Y
Mermet E Screen KOOLBLACK 0.5% *	8	0.5%	122"	Y	14.60	0.025	Y	Y	Y	Y
Mermet E Screen KOOLBLACK 1% *	8	1%	122"	Y	12.95	0.021	Y	Y*	Y	Y
Mermet E Screen KOOLBLACK 3% *	8	3%	122"	Y	11.30	0.020	Y	Y*	Y	Y
Mermet E Screen KOOLBLACK 5% *	7	5%	122"	Y	10.60	0.019	Y	Y*	Y	Y
Mermet E Screen KOOLBLACK 10% *	7	10%	122"	Y	10.30	0.020	Y	Y	Y	Y
Mermet Elba Daylight <1% *	4	<1%	118"	Y	5.60	0.022	N	Y	Y	Y
Mermet Elba Twilight 0% *	5	0%	118"	Y	11.80	0.027	N	Y	Y	N
Mermet Flocké 0% * Price Grid 8 + 15%	8+15%	0%	94.5"	Y	15.93	0.020	Y	N	N	N
Mermet GreenScreen Evolve 3% *	5	3%	118"	N	8.85	0.029	Y	Y	Y	Y
Mermet GreenScreen Revive 1% *	6	1%	118"	N	5.87	0.019	Y	Y	Y	Y
Mermet GreenScreen Revive 5% *	5	5%	118"	N	5.01	0.017	Y	Y	Y	Y
Mermet M Screen 1%	6	1%	122"	Y	13.12	0.022	Y	Y*	Y	Y
Mermet M Screen 3%	5	3%	122"	Y	12.70	0.022	Y	Y*	Y	Y
Mermet M Screen 5% *	5	5%	122"	Y	11.30	0.022	Y	Y*	Y	Y
Mermet M Screen Deco 3%	6	3%	98"	Y	12.21	0.023	Y	N	Y	Y
Mermet M Screen Deco 5% *	6	5%	98"	Y	11.30	0.020	Y	N	Y	Y
Mermet Natte 3% *	7	3%	122"	Y	16.40	0.023	Y	N	Y	Y
Mermet Natte 5% *	6	5%	122"	Y	14.10	0.022	Y	N	Y	Y
Mermet Natte 10% *	6	10%	122"	Y	13.50	0.021	Y	N	Y	Y
Mermet S Screen 1% *	6	1%	122"	N	19.10	0.041	Y	N	Y	Y
Mermet S Screen 4% *	6	4%	122"	N	18.90	0.037	Y	N	Y	Y
Mermet S Screen Naturals 5% *	6	5%	98"	N	15.00	0.042	Y	N	Y	Y
Mermet Satine 1% *	7	1%	122"	N	17.80	0.033	Y	N	Y	Y
Mermet Satine 5% *	6	5%	122"	N	15.40	0.032	Y	N	Y	Y
Mermet Sofia Daylight <1% *	4	<1%	118"	N	5.10	0.014	N	Y	Y	N
Mermet Sofia Twilight 0%	5	0%	118"	Y	11.00	0.019	N	Y	Y	N
Mermet Sparta Twilight 0%-Matching Back	5	0%	126"	Y	9.90	0.014	Y	N	Y	N
Mermet Sparta Twilight 0%-White Back	5	0%	126"	Y	9.90	0.014	Y	N	Y	N
Mermet T Screen 1% *	6	1%	122"	Y	13.83	0.027	Y	Y*	Y	Y
Mermet T Screen 3% *	6	3%	122"	Y	12.59	0.027	Y	Y*	Y	Y
Mermet T Screen Deco 1% *	6	1%	122"	Y	13.76	0.028	Y	N	Y	Y
Mermet T Screen Deco 3% *	6	3%	122"	Y	12.98	0.028	Y	N	Y	Y

* Select SKU's subject to Special Order *Fire Classifications are subject to change. Please contact Porter Preston for current information.



FABRICS	Price Grid	% Openness	Max Fabric Width	Railroad	Weight oz/sq yd	Thickness	Commercial Fire Rating NFPA 701	MA H4900 Compliant/ Antimony Free	Green Guard Gold	Fungal Resistance ASTM G21
Mermet T Screen Deco 5%	5	5%	122"	Y	11.89	0.028	Y	N	Y	Y
Mermet T Screen KOOLBLACK 1% *	7	1%	122"	Y	13.54	0.024	Y	N	Y	Y
Mermet T Screen KOOLBLACK 3% *	7	3%	122"	Y	13.27	0.029	Y	N	Y	Y
Mermet Vizela <1% *	8	<1%	94.5"	Y	8.70	0.013	Y	Y	Y	Y
Mermet Zora Twilight 0%-Matching Back*	4	0%	126"	N	11.00	0.017	N	Y	Y	N
Mermet Zora Twilight 0%-White Back *	4	0%	126"	N	12.80	0.021	N	Y	Y	N
Phifer SW 1000 25% *	3	25%	96"	Y	8.80	0.020	Y	N	Y	Y
Phifer SW 2000 5%	5	5%	126"	Y	14.40	0.021	Y	N	Y	Y
Phifer SW 2100 10%	4	10%	98"	Y	12.90	0.021	Y	N	Y	Y
Phifer SW 2360 10%	4	10%	126"	Y	10.40	0.019	Y	N	Y	Y
Phifer SW 2390 5%	4	5%	126"	Y	11.80	0.017	Y	Y*	Y	Y
Phifer SW 2410 3%	5	3%	126"	Y	14.10	0.020	Y	Y*	Y	Y
Phifer SW 2500 1%	5	1%	126"	Y	16.20	0.024	Y	Y*	Y	Y
Phifer SW 2701 1%	5	1%	126"	Y	14.60	0.027	Y	N	Y	Y
Phifer SW 2703 3%	5	3%	126"	Y	14.00	0.028	Y	N	Y	Y
Phifer SW 2705 5% *	5	5%	126"	Y	11.80	0.025	Y	N	Y	Y
Phifer SW 2710 10% *	4	10%	98"	Y	10.40	0.023	Y	N	Y	Y
Phifer SW 3000 14%	4	14%	96"	Y	13.46	0.028	Y	N	Y	Y
Phifer SW 4000 5%	4	5%	126"	Y	18.00	0.032	Y	N	Y	Y
Phifer SW 4001 1%	5	1%	126"	Y	21.30	0.033	Y	N	Y	Y
Phifer SW 4100 10% *	4	10%	98"	Y	16.70	0.032	Y	N	Y	Y
Phifer SW 4400 3%	5	3%	126"	Y	19.90	0.034	Y	N	Y	Y
Phifer SW 4500 5% *	5	5%	126"	Y	14.40	0.024	Y	N	Y	Y
Phifer SW 4550 5% *	5	5%	98"	Y	13.00	0.025	Y	N	Y	Y
Phifer SW 4600 3%	5	3%	126"	Y	17.40	0.030	Y	N	Y	Y
Phifer SW 4650 3%	5	3%	98"	Y	13.30	0.026	Y	N	Y	Y
Phifer SW 4800 1%	5	1%	126"	Y	18.50	0.036	Y	N	Y	Y
Phifer SW 4901 1%	5	1%	98"	Y	15.85	0.028	Y	N	Y	Y
Phifer SW 4903 3%	5	3%	98"	Y	14.90	0.027	Y	N	Y	Y
Phifer SW 5000 1%, 3%, 5%, 7%, 10%	5	1, 3, 5, 7, 10	98"	Y	12.5-17.3	.030-.057	Y*	N	Y	Y
Phifer SW 5500 5% *	6	5%	98"	Y	11.80	0.026	N	Y	Y	Y
Phifer SW 7001 0% *	7	0%	118"	N	11.90	0.023	Y	N	Y	Y
Phifer SW 7100 0%	5	0%	96"	N	21.60	0.025	Y	N	Y	Y
Phifer SW 7200R 0%	5	0%	118"	N	11.06	0.024	N	N	Y	Y
Phifer SW 7250R LF	4	LF	118"	N	6.19	0.018	N	N	Y	Y
Phifer SW 7300 0%	6	LF	118"	N	13.60	0.026	Y	N	Y	Y
Phifer SW 7350 LF	4	0%	118"	N	7.10	0.026	Y	N	Y	Y
Phifer SW 7400 0%	7	0%	118"	N	12.53	0.029	Y	N	Y	Y
Phifer SW 7450 LF	4	LF	118"	N	6.54	0.026	N	N	Y	Y
Phifer SW 7500 0%	5	0%	118"	N	12.14	0.016	Y	N	Y	Y
Phifer SW 7700R 0%	4	0%	118"	N	13.60	0.028	N	N	Y	Y
Phifer SW 7750R LF *	3	LF	118"	N	8.80	0.023	N	N	Y	Y
Phifer SW 7800 0%	6	0%	118"	N	12.90	0.026	Y	N	Y	Y
Phifer SW 7850 LF	5	LF	118"	N	7.40	0.027	Y	N	Y	Y
Phifer SW 8000 3%	5	3%	118"	N	7.35	0.019	Y	Y	Y	Y
Phifer SW Basic 1% *	4	1%	126"	Y	17.20	0.026	Y	N	Y	Y
Phifer SW Basic 3%	4	3%	126"	Y	16.40	0.025	Y	N	Y	Y
Phifer SW Basic 5%	3	5%	126"	Y	14.10	0.022	Y	N	Y	Y
Phifer SW Infinity2 1% *	7	1%	98"	Y	13.90	0.032	Y	N	Y	Y
Phifer SW Infinity2 3% *	7	3%	98"	Y	13.69	0.031	Y	N	Y	Y
Phifer SW Infinity2 5%	7	5%	98"	Y	12.82	0.030	Y	N	Y	Y
Phifer SW Privacy 0.1%	5	0.1%	126"	Y	18.90	0.034	Y	N	Y	Y

* Select SKU's Subject to Special Order *Fire Classifications are subject to change. Please contact Porter Preston for current information.



FABRICS	Price Grid	% Openness	Max Fabric Width	Railroad	Weight oz/sq yd	Thickness	Commercial Fire Rating NFPA 701	MA H4900 Compliant/ Antimony Free	Green Guard Gold	Fungal Resistance ASTM G21
Texstyle 3000HT 3% *	3	3%	98.4"	N	12.24	0.024	Y	N	Y	Y
Texstyle 3000 HT 5% *	3	5%	98.4"	N	11.65	0.026	Y	N	Y	Y
Texstyle 3000 Net 1%	3	1%	118"	Y	15.28	0.026	Y	N	Y	Y
Texstyle 3000 Net 3%	2	3%	118"	Y	13.12	0.022	Y	N	Y	Y
Texstyle 3000 Net 5%	2	5%	118"	Y	12.39	0.022	Y	N	Y	Y
Texstyle 3000 Net 10%	2	10%	118"	Y	11.36	0.020	Y	N	Y	Y
Texstyle 3000 Net Privacy <1%	3	<1%	118"	Y	15.28	0.026	Y	N	Y	Y
Texstyle 4000 Net 3%	3	3%	118"	Y	16.07	0.029	Y	N	Y	Y
Texstyle 4000 Net 5% *	3	5%	118"	Y	15.34	0.027	Y	N	Y	Y
Texstyle 4700P <1% *	4	<1%	98.4"	N	18.58	0.035	Y	N	Y	Y
Texstyle Ambient Renew 1% *	5	1%	118"	Y	11.80	0.021	Y	Y	N	N
Texstyle Ambient Renew 5% *	4	5%	118"	Y	9.00	0.019	Y	Y	N	N
Texstyle Avesta 0% *	7	0%	80.7"	Y	14.75	0.035	N	Y	N	N
Texstyle Avesta 1% *	6	1%	80.7"	Y	10.91	0.029	N	Y	N	N
Texstyle Balmoral 0%	7	0%	118"	N	11.50	0.023	N	Y	Y	N
Texstyle Balmoral 6%	5	6%	118"	N	6.49	0.022	N	Y	Y	N
Texstyle Chambray 1% *	5	1%	78.7"	Y	5.31	0.016	N	Y	N	N
Texstyle Chateau <1% *	1	<1%	118"	Y	6.19	0.012	N	N	N	N
Texstyle Chateau 0%	3	0%	118"	Y	10.03	0.018	N	N	N	N
Texstyle Chenille 1% *	4	1%	78.7"	Y	4.42	0.026	N	Y	N	N
Texstyle EnviroScreen 2% *	8	2%	94.5"	N	7.37	0.020	Y	Y	Y	N
Texstyle Falun 1% *	7	1%	78.7"	Y	4.72	0.012	N	Y	N	N
Texstyle Jersey 0% *	6	0%	118"	N	13.27	0.028	N	Y	Y	N
Texstyle Jersey 10% *	5	10%	118"	N	7.67	0.025	N	Y	Y	N
Texstyle Karuna 16% *	6	16%	78.7"	Y	5.60	0.022	N	Y	N	N
Texstyle Kleenscreen 0% *	4	0%	118"	N	16.96	0.027	Y	N	Y	Y
Texstyle KleenScreen 1%	2	1%	118"	N	14.25	0.024	Y	N	Y	Y
Texstyle KleenScreen 3%	2	3%	118"	N	14.01	0.022	Y	N	Y	Y
Texstyle KleenScreen 5%	2	5%	118"	N	13.12	0.022	Y	N	Y	Y
Texstyle Mandal 3% *	6	3%	78.7"	Y	3.83	0.012	N	Y	N	N
Texstyle Mesa 0% *	6	0%	118"	N	12.09	0.019	Y	N	Y	N
Texstyle Mesa 1% *	4	1%	118"	N	6.93	0.019	Y	Y	Y	N
Texstyle Milano <1% *	1	<1%	78.7"	Y	5.01	0.016	N	Y	N	N
Texstyle OmniaScreen 3% *	7	3%	110"	Y	13.27	0.022	Y	N	Y	N
Texstyle Panama <1% *	5	<1%	92.5"	Y	8.26	0.016	N	Y	N	N
Texstyle Sanctuary 0%	6	0%	118"	N	12.68	0.024	N	Y	Y	Y
Texstyle Sanctuary 3%	4	3%	118"	N	6.05	0.016	N	Y	Y	Y
Texstyle Silverscreen 2% *	8	2%	110"	N	11.80	0.020	Y	N	Y	N
Texstyle Silverscreen 4% *	8	4%	94.5"	N	11.80	0.020	Y	N	Y	N
Texstyle Tempe 0% *	4	0%	118"	N	11.80	0.012	Y	N	Y	Y
Texstyle Torino 0% *	4	0%	92.5"	Y	10.32	0.020	N	Y	N	N
Texstyle Trento <1% *	6	<1%	78.7"	Y	9.14	0.024	N	Y	N	N
Texstyle Tusk 0%	5	0%	118"	N	10.62	0.017	N	N	Y	Y
Texstyle Tusk 1% *	3	1%	118"	N	5.00	0.012	N	N	Y	Y
Texstyle Vasso 0% *	5	0%	118"	N	10.18	0.014	Y	Y	Y	N
Texstyle Verona 1% *	4	1%	92.5"	Y	5.31	0.016	N	Y	N	N
Texstyle Vista 0% *	6	0%	110"	N	11.15	0.021	N	Y	Y	N
Texstyle X Weave Zero <1% *	4	<1%	126"	N	19.17	0.033	Y	N	Y	Y
Texstyle X Weave 5% *	4	5%	126"	Y	15.63	0.032	Y	N	Y	Y
Texstyle X Weave 10% *	3	10%	126"	Y	13.86	0.027	Y	N	Y	Y

* Select SKU's Subject to Special Order *Fire Classifications are subject to change. Please contact Porter Preston for current information.

PRISTINE

ESSENTIALS · SIGNATURE · LUX

PRICE GRID 1 MSRP

FABRICS	WINDOW OPENING															
		36"	42"	48"	54"	60"	66"	72"	84"	96"	108"	120"	132"	144"	156"	168"
ICF Duplex 0%	36"	171	181	185	195	204	209	219	233	333	371	394	494	523	556	879
ICF Linen Glass 0%	48"	181	190	200	209	219	228	238	252	356	394	423	523	556	589	917
ICF Moire 0%	60"	190	200	214	223	233	242	252	276	390	418	513	551	589	627	950
ICF NLFG 0%	72"	200	214	223	238	247	261	271	295	413	442	542	584	622	931	993
ICF Opaque 0%	84"	214	223	238	252	261	276	290	314	432	470	570	613	656	964	1031
ICF TFR <1%	96"	223	238	252	266	280	295	309	409	456	494	599	646	689	1002	1064
ICF Translucent Plus <1%	108"	233	247	261	280	295	309	323	428	480	518	627	675	722	1036	1102
Textstyle Chateau <1%*	120"	242	261	276	295	309	323	342	461	504	546	656	703	755	1074	1140
Textstyle Milano <1%*	132"	252	271	290	304	323	342	361	480	523	627	684	736	784	1107	1178
	144"	261	280	299	318	337	356	375	499	546	651	708	765	1069	1140	1216
	156"	271	295	314	333	356	375	394	518	570	675	736	793	1102	1178	1254
	168"	285	304	328	347	371	390	413	537	594	703	765	827	1135	1211	1292
	180"	295	314	337	361	385	409	432	561	613	727	793	855	1164	1249	1330
	192"	304	328	352	375	399	423	508	580	637	751	822	884	1197	1283	1368

● Width (Inches)

● Height (Inches)

PRICE GRID 2 MSRP

FABRICS	WINDOW OPENING															
		36"	42"	48"	54"	60"	66"	72"	84"	96"	108"	120"	132"	144"	156"	168"
Textstyle 3000 Net 3%	36"	181	190	200	204	214	223	233	252	352	394	418	523	556	589	912
Textstyle 3000 Net 5%	48"	190	200	214	223	233	242	257	276	380	423	456	561	599	632	960
Textstyle 3000 Net 10%	60"	204	214	228	238	252	266	276	299	418	456	551	594	637	679	1007
Textstyle KleenScreen 1%	72"	214	228	242	257	271	285	299	328	447	485	584	637	679	993	1055
Textstyle KleenScreen 3%	84"	228	242	261	276	290	304	323	352	475	518	627	675	717	1036	1102
Textstyle KleenScreen 5%	96"	242	257	276	290	309	328	342	451	504	551	660	708	760	1078	1150
	108"	252	271	290	309	328	347	366	475	532	580	694	746	803	1126	1197
	120"	266	285	304	328	347	366	385	508	561	670	727	784	841	1169	1245
	132"	276	299	318	342	366	385	409	537	589	698	765	822	1131	1211	1292
	144"	290	314	337	361	385	409	432	561	618	732	798	860	1173	1259	1340
	156"	299	328	352	375	399	428	456	584	646	760	831	898	1216	1302	1387
	168"	314	342	366	394	418	447	475	608	675	793	865	936	1254	1344	1435
	180"	323	352	380	409	437	466	499	637	703	827	903	974	1297	1387	1482
	192"	337	366	399	428	456	485	580	660	732	855	936	1012	1335	1435	1530

● Width (Inches)

● Height (Inches)

PRICE GRID 3 MSRP

FABRICS	WINDOW OPENING															
		36"	42"	48"	54"	60"	66"	72"	84"	96"	108"	120"	132"	144"	156"	168"
ICF Vision Plus 0%*	36"	190	200	209	223	233	242	252	276	375	418	451	561	599	632	960
Phifer SW 1000 25%*	48"	204	219	228	242	257	266	280	309	413	456	561	603	646	689	1021
Phifer SW 7750R LF*	60"	219	233	247	261	276	295	309	337	456	499	603	651	698	1012	1078
Phifer SW Basic 5%	72"	233	252	266	285	299	318	337	437	494	537	646	703	751	1069	1140
Textstyle 3000HT 3%*	84"	247	266	285	304	323	342	361	470	527	575	694	751	1050	1126	1202
Textstyle 3000 HT 5%*	96"	266	285	304	328	347	371	390	504	565	675	736	798	1102	1183	1259
Textstyle 3000 Net 1%	108"	280	299	323	347	371	394	418	537	603	713	779	846	1154	1240	1321
Textstyle 3000 Net Privacy <1%	120"	295	318	342	371	394	418	442	580	637	755	827	893	1207	1292	1382
Textstyle 4000 Net 3%	132"	314	337	366	394	418	447	475	608	675	793	869	936	1259	1349	1439
Textstyle 4000 Net 5%*	144"	328	356	385	413	442	470	561	641	708	831	912	983	1311	1406	1501
Textstyle Chateau 0%*	156"	342	371	404	437	466	499	589	670	793	874	955	1031	1363	1458	1558
Textstyle Tusk 1%*	168"	356	390	423	456	489	523	613	703	827	912	998	1311	1411	1515	1620
Textstyle X Weave 10%*	180"	371	404	442	475	513	546	641	732	865	950	1040	1359	1463	1572	1677
	192"	385	423	461	499	537	570	670	765	898	988	1083	1401	1515	1625	1739

● Width (Inches)

● Height (Inches)



PRICE GRID 4 MSRP

FABRICS		WINDOW OPENING															
		36"	42"	48"	54"	60"	66"	72"	84"	96"	108"	120"	132"	144"	156"	168"	
ICF Wide Shade 0%	Phifer SW 7700R 0%	36"	204	219	233	242	257	271	285	309	418	466	499	613	656	698	1031
Mermet Elba Daylight <1% *	Phifer SW Basic 1% *	48"	223	238	257	271	285	304	318	352	461	513	622	675	722	770	1112
Mermet Sofia Daylight <1% *	Phifer SW Basic 3%	60"	242	261	280	299	318	333	352	390	518	565	679	736	789	1112	1188
Mermet Zora Twilight 0%-Matching Back *	Textstyle 4700P <1% *	72"	261	280	304	323	347	366	390	504	565	618	736	798	860	1188	1268
Mermet Zora Twilight 0%-White Back *	Textstyle Ambient Renew 5% *	84"	280	304	328	352	375	399	423	542	613	727	798	860	926	1259	1344
Phifer SW 2100 10%	Textstyle Chenille 1% *	96"	299	323	352	380	404	432	461	584	656	779	855	922	1240	1330	1420
Phifer SW 2360 10%	Textstyle Kleenscreen 0% *	108"	318	347	375	404	437	466	494	622	703	831	912	983	1311	1406	1501
Phifer SW 2390 5%	Textstyle Mesa 1% *	120"	337	366	399	432	466	499	527	675	751	884	964	1045	1378	1477	1577
Phifer SW 2710 10% *	Textstyle Sanctuary 3%	132"	356	390	423	461	494	527	627	717	798	931	1021	1107	1444	1549	1658
Phifer SW 3000 14%	Textstyle Tempe 0% *	144"	375	413	447	485	523	561	660	755	841	983	1078	1169	1511	1625	1734
Phifer SW 4000 5%	Textstyle Torino 0% *	156"	394	432	475	513	551	594	698	798	941	1036	1135	1463	1577	1696	1815
Phifer SW 4100 10% *	Textstyle Verona 1% *	168"	409	456	499	542	584	627	732	836	983	1088	1192	1525	1644	1767	1891
Phifer SW 7250R LF	Textstyle X Weave 5% *	180"	432	480	523	570	618	660	765	879	1031	1135	1249	1587	1715	1838	1967
Phifer SW 7350 LF	Textstyle X Weave Zero <1% *	192"	451	499	546	599	646	746	803	917	1074	1188	1306	1648	1781	1914	2047
Phifer SW7450 LF																	

● Width (Inches)

● Height (Inches)

PRICE GRID 5 MSRP

FABRICS		WINDOW OPENING															
		36"	42"	48"	54"	60"	66"	72"	84"	96"	108"	120"	132"	144"	156"	168"	
Mermet E Screen 5%	Phifer SW 4550 5% *	36"	219	233	247	261	280	295	309	342	451	504	542	660	708	755	1093
Mermet E Screen 10%	Phifer SW 4600 3%	48"	238	257	276	295	314	333	352	390	508	565	675	732	789	1112	1183
Mermet Elba Twilight 0% *	Phifer SW 4650 3%	60"	261	280	304	328	347	371	394	508	575	627	741	808	869	1197	1278
Mermet GreenScreen Evolve 3% *	Phifer SW 4800 1%	72"	285	309	333	361	385	409	432	556	627	689	812	884	950	1287	1373
Mermet GreenScreen Revive 5% *	Phifer SW 4901 1%	84"	309	337	366	394	423	451	480	603	684	808	884	955	1278	1373	1468
Mermet M Screen 3%	Phifer SW 4903 3%	96"	333	361	394	428	456	489	523	656	736	865	950	1031	1359	1458	1558
Mermet M Screen 5% *	Phifer SW 5000 1%, 3%, 5%, 7%, 10%	108"	352	390	423	456	494	527	561	703	793	931	1021	1107	1439	1544	1653
Mermet Sofia Twilight 0%	Phifer SW 7100 0%	120"	375	413	451	489	527	565	665	760	846	988	1088	1178	1520	1634	1748
Mermet Sparta Twilight 0%-Matching Back	Phifer SW 7200R 0%	132"	399	437	480	523	561	603	703	808	903	1050	1154	1254	1601	1720	1838
Mermet Sparta Twilight 0%-White Back	Phifer SW 7500 0%	144"	418	466	508	551	599	641	746	855	1007	1112	1221	1553	1682	1805	1933
Mermet T Screen Deco 5%	Phifer SW 7850 LF	156"	442	489	537	584	632	679	789	907	1059	1173	1287	1629	1762	1895	2028
Phifer SW 2000 5%	Phifer SW 8000 3%	168"	461	513	565	618	665	717	831	955	1116	1235	1354	1701	1843	1981	2119
Phifer SW 2410 3%	Phifer SW Privacy 0.1%	180"	485	542	594	646	703	812	869	1002	1169	1297	1425	1777	1919	2066	2214
Phifer SW 2500 1%	Textstyle Ambient Renew 1% *	192"	508	565	622	679	736	850	912	1050	1226	1354	1492	1848	2000	2152	2304
Phifer SW 2701 1%	Textstyle Balmoral 6%																
Phifer SW 2703 3%	Textstyle Chambray 1% *																
Phifer SW 2705 5% *	Textstyle Jersey 10% *																
Phifer SW 4001 1%	Textstyle Panama <1% *																
Phifer SW 4400 3%	Textstyle Tusk 0% *																
Phifer SW 4500 5% *	Textstyle Vasso 0% *																

● Width (Inches)

● Height (Inches)

PRICE GRID 6 MSRP

FABRICS		WINDOW OPENING															
		36"	42"	48"	54"	60"	66"	72"	84"	96"	108"	120"	132"	144"	156"	168"	
Mermet E Screen 0.5% *	Mermet T Screen 3% *	36"	242	261	280	299	323	342	361	399	518	580	627	755	808	865	1211
Mermet E Screen 1% *	Mermet T Screen Deco 1% *	48"	271	295	318	342	366	390	413	461	589	660	784	850	917	1249	1335
Mermet E Screen 3%	Mermet T Screen Deco 3% *	60"	299	328	356	385	413	442	470	594	675	741	874	950	1021	1363	1458
Mermet E Screen Deco 1% *	Phifer SW 5500 5% *	72"	328	361	394	428	461	494	523	660	751	879	964	1050	1131	1482	1582
Mermet E Screen Deco 3%	Phifer SW 7300 0%	84"	356	394	432	470	504	542	580	722	822	960	1055	1145	1235	1596	1710
Mermet GreenScreen Revive 1% *	Phifer SW 7800 0%	96"	385	428	470	508	551	594	637	789	893	1040	1145	1245	1591	1715	1834
Mermet M Screen 1%	Textstyle Avesta 1% *	108"	418	466	508	556	603	646	694	855	964	1126	1235	1344	1701	1829	1957
Mermet M Screen Deco 3%	Textstyle Jersey 0% *	120"	447	499	546	599	646	698	746	926	1040	1207	1325	1439	1805	1943	2081
Mermet M Screen Deco 5% *	Textstyle Karuna 16% *	132"	475	532	584	637	694	746	860	993	1112	1287	1416	1539	1914	2062	2204
Mermet Natte 5% *	Textstyle Mandal 3% *	144"	504	561	622	679	741	798	917	1055	1230	1368	1506	1867	2019	2176	2328
Mermet Natte 10% *	Textstyle Mesa 0% *	156"	532	599	660	722	784	850	974	1116	1306	1449	1596	1967	2128	2290	2456
Mermet S Screen 1% *	Textstyle Sanctuary 0%	168"	561	627	698	765	831	898	1026	1183	1378	1530	1686	2062	2233	2408	2579
Mermet S Screen 4% *	Textstyle Trento <1% *	180"	589	660	732	808	879	1002	1078	1245	1449	1610	1772	2161	2342	2522	2703
Mermet S Screen Naturals 5% *	Textstyle Vista 0% *	192"	618	694	770	846	922	1055	1135	1306	1520	1691	1862	2261	2446	2636	2826

*Black, Slate & Storm Façade

● Width (Inches)

● Height (Inches)



PRICE GRID 9 MSRP

BRACKETS & ACCESSORIES															
Motorized Shade Coupler per Band	156														
SL Opulence Round Bkt w Cover 45mm Proj , SN, Blk, Wht, AB, Pair	64														
SL Opulence Square Bkt w Cover 45mm Proj, SN, Blk, Wht, AB, Pair	64														
CORDLESS															
EasySpring Plus/EasySpring AIR	110														
MANUAL CLUTCH ACCESSORIES															
Galaxy G200 Clutch Skyline Geared 1-1/2", SN, AB, Wht, Blk	50														
Galaxy G400 Clutch Skyline Geared 1-1/2" Wht, Blk	60														
Spg Asst Geared 45" L/R, Wht, Blk	120														
Spg Asst Booster w Connector SL20	50														
Clutch SL20 1-1/2" Exterior, Blk, Wht	37														
Metal Chain Color Upcharge	15														
METAL FASCIA-Brackets Included															
	36"	42"	48"	54"	60"	66"	72"	84"	96"	108"	120"	132"	144"	156"	168"
3" Fascia	68	75	81	91	99	104	111	128	140	157	172	186	200	215	230
4" Fascia	88	99	105	113	125	134	140	160	176	195	212	230	249	266	283
5.5" Fascia	136	153	170	187	204	220	239	254	273	288	306	324	340	357	376
7" Fascia Dual	421	476	529	583	636	689	743	795	849	901	955	1009	1062	1117	1168
● Width (Inches)															
FABRIC COVERED CASSETTES/VALANCE															
	36"	42"	48"	54"	60"	66"	72"	84"	96"	108"	120"	132"	144"	156"	168"
Curved Cassette 100	102	113	128	139	154	165	177	204	229	254	279	305	331	356	383
Curved Cassette 120	112	128	140	157	170	184	199	227	254	282	311	339	367	395	423
Square Cassette 110	112	128	140	157	170	184	199	227	254	282	311	339	367	395	423
Soft Valance	53	61	67	74	81	85	88	106	116	130	140	153	164	175	184
● Width (Inches)															
HEM BAR															
	36"	42"	48"	54"	60"	66"	72"	84"	96"	108"	120"	132"	144"	156"	168"
Exposed Hem Bar, ANO, BLK, WHT	43	54	60	66	72	76	81	88	100	110	121	134	143	155	166
Fabric Wrapped Hembar, ANO, BLK, WHT	47	59	66	72	79	84	89	97	110	121	133	147	157	171	183
Grommited Hem Bar with Hold Downs, BLK	147														
● Width (Inches)															
HANGER															
	36"	42"	48"	54"	60"	66"	72"	84"	96"	108"	120"	132"	144"	156"	168"
I Clip Recess Closure (No Lip) 16' , WHT	42	50	55	63	71	77	84	99	111	126	139	154	167	181	195
● Width (Inches)															
POCKET-CONTRACT															
	36"	42"	48"	54"	60"	66"	72"	84"	96"	108"	120"	132"	144"	156"	168"
AP-44 Shade Pocket, 4'x4"x10' ANO, WHT	101	118	134	151	168	185	202	235	269	302	336	n/a	n/a	n/a	n/a
AP-55 Shade Pocket, 5'x5"x10' ANO, WHT	120	139	159	179	199	219	239	279	319	359	398	n/a	n/a	n/a	n/a
AP-66 Shade Pocket, 6'x6"x10' WHT	135	158	180	203	225	248	270	315	360	405	450	n/a	n/a	n/a	n/a
AP-79 Shade Pocket, 7'x9"x10' WHT	374	436	499	561	623	686	748	873	997	1122	1247	n/a	n/a	n/a	n/a
Note: Brackets for Pockets Priced Separately															
POCKET-CLOSURE															
	36"	42"	48"	54"	60"	66"	72"	84"	96"	108"	120"	132"	144"	156"	168"
Bottom Closure 2" Return, 10' ANO, WHT	27	32	36	41	46	50	55	64	73	82	91	n/a	n/a	n/a	n/a
Bottom Closure 3" Return, 10' ANO, WHT	36	42	48	53	59	65	71	83	95	107	119	n/a	n/a	n/a	n/a
Bottom Closure 4" Return, 10' ANO, WHT	43	50	57	64	71	79	86	100	114	129	143	n/a	n/a	n/a	n/a
Bottom Closure 5" Return, 10' ANO, WHT	66	77	88	99	110	121	132	154	176	198	220	n/a	n/a	n/a	n/a
POCKET-END PLATES															
AP-44e, Pocket Endplate, 4'x4" ANO, WHT, PR	52														
AP-55e, Pocket Endplate, 5'x5" ANO, WHT, PR	54														
AP-66e, Pocket Endplate, 6'x6" WHT Only, PR	68														
AP-79e, Pocket Endplate, 7'x 9" WHT Only, PR	157														
SIDE CHANNELS- PRICE GRID IS BASED ON HEIGHT															
	36"	48"	60"	72"	84"	96"	108"	120"	132"	144"	156"	168"	180"	192"	216"
Side Mount U Channel 2.5" x 1" BLK, BZ, SLV, WHT, EA	80	106	134	160	187	213	240	266	293	319	347	373	401	426	437
Surface Mount I Side Channel ANO, WHT, EA	63	73	84	94	104	115	125	146	167	188	209	230	251	271	292
● Height (Inches)															
Note: Side Rails include black 7mm x 5mm black brush strip. White and Black Side Channel End Caps Available															
SILL CHANNEL-PRICE GRID IS BASED ON WIDTH															
	36"	42"	48"	54"	60"	66"	72"	84"	96"	108"	120"	132"	144"	156"	168"
IB Mount Sill Channel 1"x1" ANO, BLK, BZ, WHT	57	66	77	86	94	106	114	134	153	178	191	209	229	248	367
● Width (Inches)															

SOMFY ZIGBEE

Part #	Somfy Zigbee Motors - Interior Only	MSRP
1241754	Sonesse 28 External Battery ZIGBEE Motor	409
1241755	Sonesse 28 Li-Ion ZIGBEE Motor	501
1241752	Sonesse 30 ULTRA Li-Ion ZIGBEE Motor	526
1245993	Sonesse 404 Li-Ion ZIGBEE Motor (USB-C)	1015
1241970	Sonesse 30 24V DC ZIGBEE Motor	669
1245920	Sonesse 404 120V AC Zigbee Motor with Fast Connector	738
1245921	Sonesse 406 120V AC Zigbee Motor with Fast Connector	906
1245922	Sonesse 409 120V AC Zigbee Motor with Fast Connector	924
Part #	Somfy Zigbee Controls and Accessories	MSRP
1871153	Ysia 1 ZIGBEE Single Channel Remote	132
1871154	Ysia 5 ZIGBEE Multichannel Remote	175
1871037	Tahoma Switch ZIGBEE (Hub Only)	410
1871038	Tahoma Switch ZIGBEE (With Ethernet Adaptor)	462
9028054	Tahoma Switch Ethernet Adaptor ONLY	62
1871217	Smart Plug ZIGBEE	93
1871573	Zigbee Decoflex 2-Channel In-Wall WHITE	339
1871572	Zigbee Decoflex 4-Channel In-Wall WHITE	339
1871577	Zigbee Decoflex 2-Channel Surface Mount WHITE	339
1871576	Zigbee Decoflex 4-Channel Surface Mount WHITE	339

SOMFY WIREFREE

Part #	Somfy External Battery RTS Motors - Interior Only	MSRP
1241230	Sonesse 28 External Battery RTS Motor	545
Part #	Somfy External Battery Accessories - (Also Compatible with Zigbee External Battery Motor)	MSRP
1870940	12V DC Plug-In Power Supply	305
9021217	Li-Ion Battery Pack for External Battery Motors	139
9018685	12V DC Reloadable Battery Tube for External Battery Motors	80
9014834	8AA Lithium Battery Pack (For 12V Reloadable Tube)	110
Part #	Somfy Internal Li-Ion Rechargeable Battery RTS Motors - Interior Only	MSRP
1240278	Roll Up 24 Li-Ion RTS Motor	405
1003297	Sonesse 28 Li-Ion RTS Motor	513
1003310	Sonesse 30 ULTRA Li-Ion RTS Motor	535
1240485	Sonesse 403 Li-Ion RTS Motor	657
Part #	Somfy Li-Ion Battery Chargers & Extension Cables (Also Compatible with Zigbee Li-Ion Motors)	MSRP
9025166	Lithium-Ion Plug-In Charger	45
9021131	Li-Ion Charging Extension Cable - 8"	14
9027294	Li-Ion Solar Panel Kit	220
9028562	Magnetic Cable Adaptor for Li-Ion Motors - 8"	23
9028560	Magnetic Rigid Cable for Li-Ion Charger - 34"	31
9028923	USB-C Li-Ion Fast Charger	55
9028565	USB-C Li-Ion Charging Extension Cable - 8"	31
9028564	USB-C Magnetic Adaptor (For USB-C Motors)	12
9028563	USB-C Magnetic Rigid Cable (For USB-C Charger)	33
9028978	USB-C Industrial Charger Station (16-Motor)	1845
9028980	USB-C 16-Cable Replacement Set for Charger Station	153



PRICE GRID 10 MSRP

SOMFY 24V DC LOW VOLTAGE

Part #	SOMFY 24 Volt DC RTS Motors - Interior	MSRP
1241142	Sonesse 30 24V DC RTS Motor	765
1134023	Sonesse 504 ULTRA 24V DC RTS Motor	1117
Part #	Somfy 24 Volt DC Low Voltage Power Options	MSRP
1822209	24V DC 1.67A Single Plug-In Power Supply	131
9027985	Weidmüller Power Connector for 24V DC Motors	17
9020005	Power Cable for 504 ULTRA 24V DC Motors	75
1870196	24V DC Power Distribution Enclosure Kit - 5 MOTOR	2165
1870192	24V DC Power Distribution Enclosure Kit - 10 MOTOR	3258
1870197	24V DC Power Distribution Enclosure Kit - 15 MOTOR	4219
1870198	24V DC Power Distribution Enclosure Kit - 20 MOTOR	5028

SOMFY 120V AC 3-WIRE LINE VOLTAGE RTS

Part #	SOMFY 120V AC Line Voltage RTS Motors	MSRP
1001636	Sonesse 404 120V AC RTS Motor with Open Leads	887
1240380	Sonesse 404 120V AC RTS Motor with Fast Connect 1.6ft	745
1240381	Sonesse 406 120V AC RTS Motor with Fast Connect 1.6ft	914
1240382	Sonesse 409 120V AC RTS Motor with Fast Connect 1.6ft	933
1001809	Sonesse 506 120V AC RTS Starhead Motor	838
1002562	Sonesse 506 ULTRA 120V AC RTS Starhead Motor	1032
1001807	Sonesse 510 120V AC RTS Starhead Motor	1108

RTS MOTOR CABLE & FAST CONNECT EXTENSION CABLE OPTIONS

Part #	LT50 RTS Motor Cable Options	MSRP
9018190	LT50 RTS Motor Cable with Open Leads - 10ft	72
9020985	LT50 RTS Motor Cable with Open Leads - 24ft	124
9028737	LT50 RTS Motor Cable with Open Leads BLACK - 10ft	81
9028738	LT50 RTS Motor Cable with Open Leads BLACK - 24ft	141
9021049	LT50 RTS Motor Cable with Nema Plug - 1.5ft	42
9021050	LT50 RTS Motor Cable with Nema Plug - 6ft	59
9021051	LT50 RTS Motor Cable with Nema Plug - 10ft	62
9021052	LT50 RTS Motor Cable with Nema Plug - 18ft	77
9021053	LT50 RTS Motor Cable with Nema Plug - 24ft	127
9020803	LT50 RTS Motor Cable with Fast Connect - 1.6ft	99
Part #	3-WIRE RTS Fast Connect Extension Cable Options	MSRP
9021157	RTS Fast Connect Extension Cable without NEMA Plug - 8.4ft	82
9021113	RTS Fast Connect Extension Cable w/ NEMA Plug - 1.4ft	58
9021114	RTS Fast Connect Extension Cable w/ NEMA Plug - 4.4ft	66
9021115	RTS Fast Connect Extension Cable w/ NEMA Plug - 8.4ft	79
9020791	RTS Fast Connect Extension Cable w/ NEMA Plug - 10.4ft	106
9020792	RTS Fast Connect Extension Cable w/ NEMA Plug - 18ft	132
9020793	RTS Fast Connect Extension Cable w/ NEMA Plug - 24ft	155
9028673	RTS Fast Connect Extension Cable w/ NEMA Plug BLACK - 18ft	132
9020794	RTS Fast Connect Extension Cable w/ NEMA Plug BLACK - 24ft	155
9026398	RTS Panel Mount Female Fast Connector	35

SOMFY RTS CONTROLS

Part #	Handheld RTS Controls - Interior Use Only	MSRP
1870571	Situo 1 RTS PURE	132
1870572	Situo 1 RTS IRON	191
1870573	Situo 1 RTS NATURAL	191
1870574	Situo 1 RTS ARCTIC	191
1870575	Situo 5 RTS PURE	174
1870576	Situo 5 RTS IRON	234
1870577	Situo 5 RTS NATURAL	234
1870578	Situo 5 RTS ARCTIC	234
1811081	Telis 16 RTS PURE	590
1811082	Telis 16 RTS SILVER	649
1805237	Telis 1 RTS Chronis PURE	469
Part #	Handheld RTS Controls – Interior and Exterior Use	MSRP
1810643	Telis 1 RTS PATIO (Outdoor Capability)	180
1810645	Telis 4 RTS PATIO (Outdoor Capability)	251
Part #	Surface Mount RTS Switches	MSRP
1871361	Smoove 1 RTS 1-Channel Surface Switch PURE	175
1871381	Smoove 4 RTS 4-Channel Surface Switch PURE	218
9015022	Smoove Frame Only PURE	6
9015023	Smoove Frame Only BLACK	18
9015025	Smoove Frame Only SILVER MATTE	18
9015238	Smoove Double Frame Only PURE	59
1871191	Smoove 1 Custom Engraved Switch (Form Required)	188
1871192	Smoove 4 Custom Engraved Switch (Form Required)	229
9027376	Smoove Custom Engraved Single Frame Only (Form Required)	29
9027377	Smoove Custom Engraved Dual Frame Only (Form Required)	101
Part #	Decoflex RTS Switches	MSRP
	DecoFlex 1-5 RTS 1-5 Channel Wallswitch WHITE	345
	DecoFlex 1-5 RTS 1-5 Channel Wallswitch BLACK	398
	Decoflex Custom Engraved Channel or Command Buttons WHITE or BLACK (Form Required)	15
	Decoflex Table Top Accessory Only, WHITE, BLACK, SILVER	73
1870908	Decoflex Wirefree RTS 3-Button (Open, Stop, Close) Wallswitch WHITE	322
1871025	Decoflex Wirefree RTS Surface 5-Channel Wallswitch WHITE	456
9028644	Decoflex Surface In-Wall Adapter	50
Part #	Miscellaneous RTS Controls	MSRP
1810872	Universal RTS Interface II (URTSI II - 16 Channel)	1057
1810791	RTS Repeater	453

SOMFY 120V AC LINE VOLTAGE 4-WIRE STANDARD

Part #	120 Volt AC Line Voltage Standard Motors	MSRP
1001553	Sonesse 404 120V AC WT 4-Wire Motor w/ Open Leads	584
1240377	Sonesse 404 120V AC WT 4-Wire Motor with Fast Connect 1.6ft	584
1240378	Sonesse 406 120V AC WT 4-Wire Motor with Fast Connect 1.6ft	609
1240379	Sonesse 409 120V AC WT 4-Wire Motor with Fast Connect 1.6ft	627
1001814	Sonesse 506 120V AC WT 4-Wire Starhead Motor	686
1002558	Sonesse 506 ULTRA 120V AC WT 4-Wire Starhead Motor	789
1001813	Sonesse 510 120V AC WT 4-Wire Starhead Motor	837
Part #	LT50 WT Motor Cable Options	MSRP
9018345	LT50 WT 4-Wire Motor Cable w/ Open Leads - 10ft	70
9021046	LT50 WT 4-Wire Motor Cable w/ Open Leads - 24ft	149
9020804	LT50 WT 4-Wire Motor Cable w/ Fast Connect - 1.6ft	99
Part #	4-Wire STANDARD Fast Connect Extension Cable Options	MSRP
9021117	4-Wire Fast Connect Extension Cable Open Leads - 4.4ft	70
9021118	4-Wire Fast Connect Extension Cable Open Leads - 8.4ft	83
9021120	4-Wire Fast Connect Extension Cable Open Leads - 16.4ft	124
9021121	4-Wire Fast Connect Extension Cable Open Leads - 22.4ft	144
Part #	4-Wire STANDARD Motor Controls	MSRP
1811416	IGC 4n1 Motor Controller (4 WT Motors)	1272
1811402	Decoflex Digital Dry Contact Switch WHITE	139
9012116	4-Wire WT Motor Tester Cable (For Limit Setting with IGC4n1)	196
1811492	IGC 4n1 RTS Radio Receiver	363
1800374	Maintained Decorator Switch Single Pole WHITE	49
1800375	Maintained Decorator Switch Double Pole WHITE	89



PRICE GRID 11 MSRP

AUTOMATE RADIO COMMUNICATION (ARC) BY ROLLESE ACMEDA

Part #	5 Volt Internal Li-Ion Rechargeable Motors	MSRP
MT01-1325-069029	ARC 5V Li-Ion ZERO 25mm 1.1nm Motor	503
MT01-1325-069037	ARC 5V Li-Ion ZERO 25mm 0.7nm Motor	503
MT01-1328-069008	ARC 5V Li-Ion ZERO 28mm 2.0nm Motor	602
MT01-1335-069002	ARC 5V Li-Ion 35mm 6nm Motor	617
MT01-1345-069003	ARC 5V Li-Ion 45mm 6nm Motor	640
MT01-1345-069004	ARC 5V Li-Ion 45mm 13nm Motor	706
Part #	5 Volt Li-Ion Rechargeable Charger and Cable Options	MSRP
MT03-0301-069007	ARC 5V USB Charging Cable ONLY 157"	13
MT03-0301-069007/8	ARC 5V USB Charger - Includes 157" Cable	33
MT03-0301-069013	5V Micro USB Charging Extension Cable 48"	21
MT03-0301-069014	5V Micro USB Charging Extension Cable 8"	14
MT03-0301-069023	5V Magnetic Charging Kit - x1 USB Cable x1 Motor Connector	20
MT03-0301-069025	5V Magnetic Motor Connector ONLY	3
MT03-0302-067002	Li-Ion Solar Panel for 5V Motors	243
Part #	12 Volt DCRF Low Voltage Motors	MSRP
MT01-1225-069002	ARC 12V DC Wired ZERO 25mm 1.1nm Hardwired Motor	371
MT01-1228-069002	ARC 12V DC Wired ZERO 28mm 2.0nm Hardwired Motor	458
Part #	12 Volt DCRF Low Voltage Power Supplies and Accessories	MSRP
MT03-0301-411005	18 Motor Distribution Panel for DCRF Motors (AC Power Cord Not Included)	573
MT03-0304-050007	AC Power Cord for 18 Motor Distribution Panel - 6ft	21
MT03-0305-069003	5V External Rechargeable Battery Pack for DCRF Motors	225
MT03-0301-069012	Connection Harness for ARC DCRF Motors	10
MTDCPS-18-25	Plug-In Power Supply for 25mm DCRF Motor	73
MTDCPS-28-35-45	Plug-In Power Supply for 28/35/45mm DCRF Motor	162
Part #	Automate RF Handheld Controls	MSRP
	ARC Push 1 Single-Channel Remote BLACK, WHITE	155
	ARC Push PRO 30-Channel Smart Remote BLACK, WHITE	370
	ARC Push 5 5-Channel Remote BLACK, WHITE	159
	ARC Push 15 15-Channel Remote BLACK, WHITE	183
Part #	Controls-Wall Mount	MSRP
MTRF-WS-1C	ARC Single Channel Cut-In Wall Switch WHITE	120
MTRF-WS-2C	ARC 2-Channel Cut-In Wall Switch WHITE	134
MTRF-WS5-FLUSH	ARC 5-Channel Surface Flush Mount Wall Switch WHITE	141
MTRF-WS-15	ARC 15-Channel Cut-In Wall Switch WHITE	148
MTRF-WS-COVER	ARC Wall Switch Screwless Cover Plate WHITE	26
	Custom Button Frame Kit ONLY 1-5, Channel for Flush Wall Switch (Pack of 10)	49
Part #	Automation Assecories	MSRP
MT02-5401-050001	Automate Pulse PRO Bridge	483
MT02-0401-069007	ARC USB Repeater WHITE	173
MT02-0302-067003	ARC Internal Sun Sensor WHITE	153

Prices represent the upcharge to motorize Pristine Roller Shades with Automate Radio Communication (ARC).

1. Choose Your Mounting Style

Decide if roller shade will sit within the window casing or cover from the outside.

- **Inside Mount (IM/IB):** The shade is installed inside the window frame or a recessed opening. This provides a sleek, custom look.
- **Outside Mount (OM/OB):** The shade is mounted on the wall, ceiling, or window molding. This is ideal for masking unattractive trim or providing better light blockage.

2. Measuring for Inside Mount

- **Width:** Measure the top, middle, and bottom of the window opening. Record the narrowest width to the nearest 1/8". This ensures the shade operates without rubbing against the frame.
- **Length:** Measure the left, center and right vertical distances. Record the longest length to the nearest 1/8".
- **Important:** Provide exact window dimensions. The factory will calculate the necessary deductions for the tube and fabric. Do not make your own adjustments.

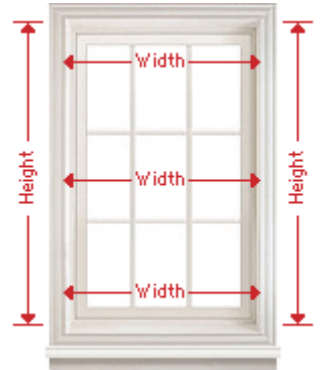

IB Measuring

3. Measuring for Outside Mount

- **Width:** Measure the window opening (or the outer edges of the trim). Add extra inches to your total for maximum privacy and to minimize light gaps. Round to the nearest 1/8".
- **Length:** Measure the height of the area you wish to cover. Ensure you add enough height to account for the mounting brackets above the window and overlap at the bottom. Round to the nearest 1/8".
- **Protrusions:** If you have a protruding window sill, measure down to the sill surface.



OB Measuring

4. Final Confirmation

- **Order Format:** Always list Width first, then Length. (Width x Length)
- **Fabric Width vs. Bracket Width:** Please note that the actual fabric will be narrower than the total shade width. This "light gap" is necessary to accommodate the mounting brackets, clutch/motor, and idler end. Standard factory deductions will be applied automatically to ensure a perfect fit.

⚠ ATTENTION: Standard measurements include the mounting hardware. If you are ordering based on a **required fabric width** specify this clearly to ensure a proper fit and adequate coverage.

Important Production Details

Fabric "Wrap" Allowance

The factory automatically adds extra fabric (the "wrap") to your provided window length to ensure the roller tube remains covered when the shade is fully extended.

- **Motorized, Clutch & Spring Roller Shades:** 10" standard wrap
- **Critical:** Measure only the **actual window opening**. Do not add extra length for the wrap; the factory handles this calculation

Tracking & Telescoping (The 3:1 Rule)

Shades with a length-to-width ratio exceeding **3:1** (more than 3 times longer than they are wide) are prone to **telescoping** where the fabric tracks unevenly or "spirals" off the roll. This is an inherent trait of roller fabrics and should be disclosed to the end-user.

Railroading & Edge Curling

When a shade's width exceeds the fabric roll's width, the material must be "railroaded" (turned sideways).

- **Note:** Railroading may cause slight curling on the outer vertical edges
- **Solution:** If edge curling is a concern, select a wider fabric to avoid turning the material

Large Shades (Over 126")

Shades exceeding 126" in width may exhibit "smile lines," waves, or tube wrinkling. These are standard aesthetic characteristics of oversized roller shades and can occasionally lead to permanent fabric ripples.

Fabric Seams

If the shade dimensions exceed the fabric roll size, a second piece of fabric will be heat-welded (spliced) to the first.

Roll Direction: Regular vs. Reverse

Regular Roll: Fabric hangs from the back of the tube closest to the glass. Best insulation and light control due to proximity to the window and yield the highest levels of energy conservation.

Reverse Roll: Fabric hangs from the front of the tube furthest from the glass. Ideal for avoiding obstructions clearing window cranks, door handles or deep trim. Reduces light gaps for corner windows or bay windows.

Telescoping & Tracking



Regular Roll

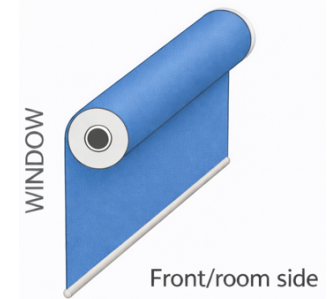

Reverse Roll

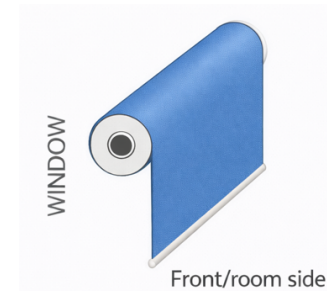

Chainhold Tension Device

The Chainhold Tension Device provides an essential, child-safe tensioning solution for chain-driven roller shades.

Safety Compliance:

To ensure full compliance with ANSI/WCMA A100.1 safety standards, this device is engineered to partially disable the shade if not installed correctly. This fail-safe mechanism ensures the tensioner is permanently secured minimizing strangulation risks.

Key Features

Rapid Integration: Designed for fast assembly and streamlined installation using available outside mounting brackets.

Minimalist Aesthetic: A sleek, compact profile that blends seamlessly into any interior décor.

Smooth & Silent: Engineered for quiet, high-efficiency performance.

Universal Compatibility: Provides fluid operation with both metal and plastic stop balls.

Certified Safety: Fully compliant with current ANSI/WCMA child safety regulations.

INSTALLATION

1. Pull the Chainhold down until the chain is fully tensioned (plunger will be fully raised).
2. Mark screw hole locations.
3. Screw device into wall.

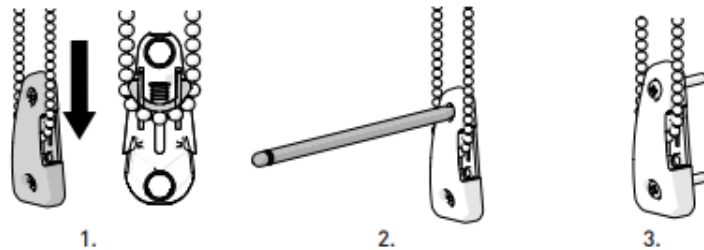

ADDITIONAL MOUNTING OPTIONS

1. With provided screws, install bracket first with large screws (use Chainhold marked screw hole locations as reference).
2. Install Chainhold into bracket with small screws.

OUTSIDE MOUNT

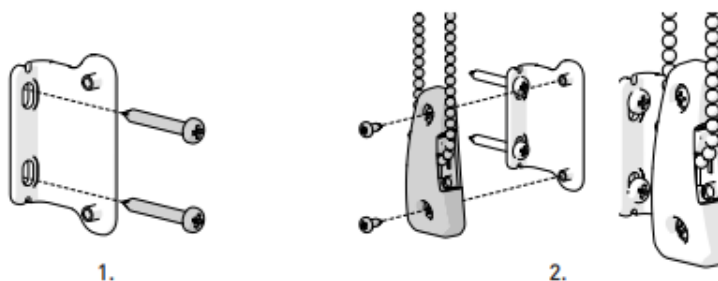

SIDE MOUNT

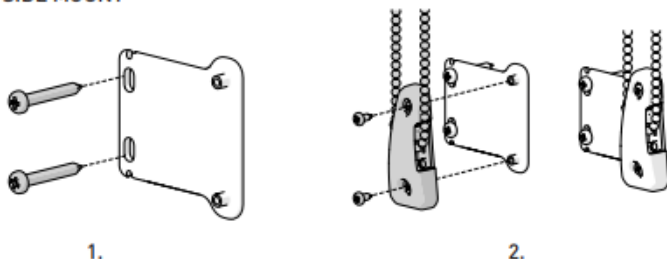

FLOOR MOUNT

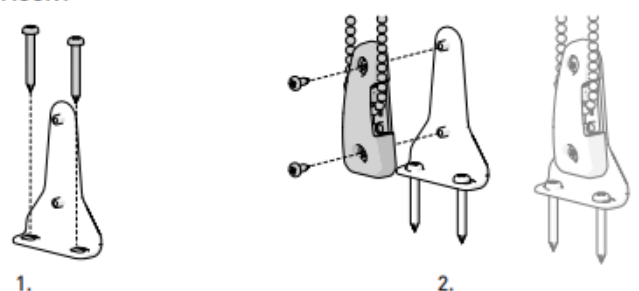

SKYLINE SERIES

SLEEK, VERSATILE AND DEPENDABLE

The Skyline™ system features a patented improvement on the smooth and dependable operating clutch technology found in the R-Series, in a sleeker and rounded profile.

With a wider array of colors and sizes, matching rounded end caps, and universal single and dual brackets, Skyline clutches offer greater versatility and ease of installation.

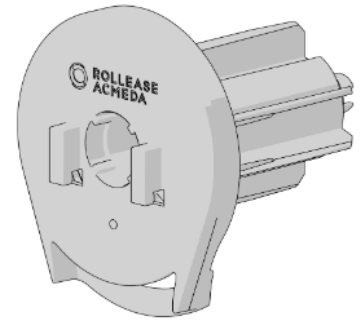

Skyline clutches are ideal for both residential and commercial applications. Skyline clutches feature patented Velvetrol™ technology, have a lifetime warranty and can be used in any roller shade where overall aesthetics are important.

- **Spring-loaded pin-end** technology is highly forgiving for greater flexibility in installation
- **Patented Velvetrol™** internal spring arrangement provides a smoother feel when pulling a shade up or down
- **Sleek, rounded end cap** and no-notch fascia design for a more polished finish
- **Universal brackets** available in standard and dual with multiple projections also available in elongated or narrow bases
- **Hooked clutches** for easy and universal performance
- **Fiberglass-** filled nylon construction provides long lasting durability



COMPATABILITY Fascia, Cassette Systems, Contract Series, Spring Assist and Link Systems

BRACKETS

SKYLINE			1.6	41	3	76			2.4	60
RIBBED		Standard Skyline brackets with a ribbed option for larger shades, and a narrow option for narrow windows	2.1	53	4	102	2.2	56	2.9	74
			2.9	74	5	127			3.6	91
			1.3	32	2.3	59			2	51
NARROW			1.6	41	3	76	1.5	38	2.4	60
			2.1	54	4	102			2.9	73
			2.9	73	5	127			2.2	56

GALAXY SERIES

PATENTED GEAR TECHNOLOGY LIFTS HEAVIER SHADES WITH MINIMAL EFFORT

The Galaxy line features patented technology that enhances clutch operation by using a process of planetary and rotating gears to assist the clutch's inner springs. This innovative technology reduces the pull required to raise heavier shades and enables lifting with minimal effort



- **Patented Velvetrol™** internal spring arrangement provides a smoother feel when pulling a shade up or down
- Option for Universal single or dual brackets for greater application
- Compatible with Skyline components
- Long-lasting Fiberglass-filled nylon construction
- Best used with bead chain
- COMPATIBILITY Fascia, Cassette Contract, Spring Assist, Link System

SPRING ASSIST

THE PERFECT COMPLEMENT TO CLUTCH TECHNOLOGY

Spring Assist combines the advanced, patented clutch technology with a spring that when pre-rotated to the designated tension, reduces the pull force required to raise heavy shades.

Spring Assist reduces the pull force on heavy shades to approximately 6 lbs (2.7 kg), even on shades weighing up to 30 lbs (13.5 kg).

- Easy-to-assemble system
- Sleeved spring provides smooth and quiet operation
- Compatible with Skyline
- No special brackets or end plugs required
- Lifetime warranty



DECORATIVE OPULENCE BRACKETS



Features

- Available in round and square options
- Elegant design removes the need for plastic bracket cover
- Quick and easy installation
- Compatible with manual, spring and motor shades
- Includes bearing for reduced noise during shade operation
- Magnetic screw cover hides screws for a seamless look
- Magnetic motor cover cleanly runs AC/DC wires through the bracket
- Skyline available in White, Black, Satin Nickel and Antique Bronze



○ White
 Round & Square
 069



● Black
 Round & Square
 050



● Satin Nickel
 Round & Square
 034



● Antique Bronze
 Round & Square
 079

Color Range



White



Black

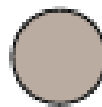

Satin Nickel



Antique Bronze

CHAIN OPTIONS

Stainless Steel – Default

Stainless Steel



Color Metal Chain Available for a Surcharge

Dungeon



Gun Metal



Medieval Brass



Mystic Red



Antique Brown



Black Coated



White Coated



Yellow Brass



DEFAULT STANDARD LOOP SIZES

DEFAULTED CHAIN LOOP LENGTH	
SHADE HEIGHT	LOOP DROP
16" - 29 7/8"	4" less shade height
30" - 35 7/8"	24" loop
36" - 41 7/8"	30" loop
42" - 47 7/8"	36" loop
48" - 53 7/8"	42" loop
54" - 59 7/8"	48" loop
60" - 65 7/8"	54" loop
66" - 71 7/8"	60" loop
72" - 77 7/8"	66" loop
78" - 89 7/8"	72" loop
90" - 101 7/8"	84" loop
102" - 113 7/8"	96" loop
114" - above	4" less shade height

CORDLESS EASY SPRING AIR



The Easy Spring Air cordless roller system is a simple yet robust balanced spring system that allows optimal shade positioning by simply placing the bottom rail in the desired location.

The single piece, adjustable spring system allows for countless spring sizes making it a breeze to balance any size shade. 16" Minimum Width up to 120" Maximum Width - Pending Shade Specification.

The smooth operation along with the ability for the end user to quickly and easily adjust tension with the shade in place makes this the most user friendly and versatile balanced shade on the market.

This system uses Skyline bracketing system, making it compatible with cassettes, fascias, and open roll brackets.

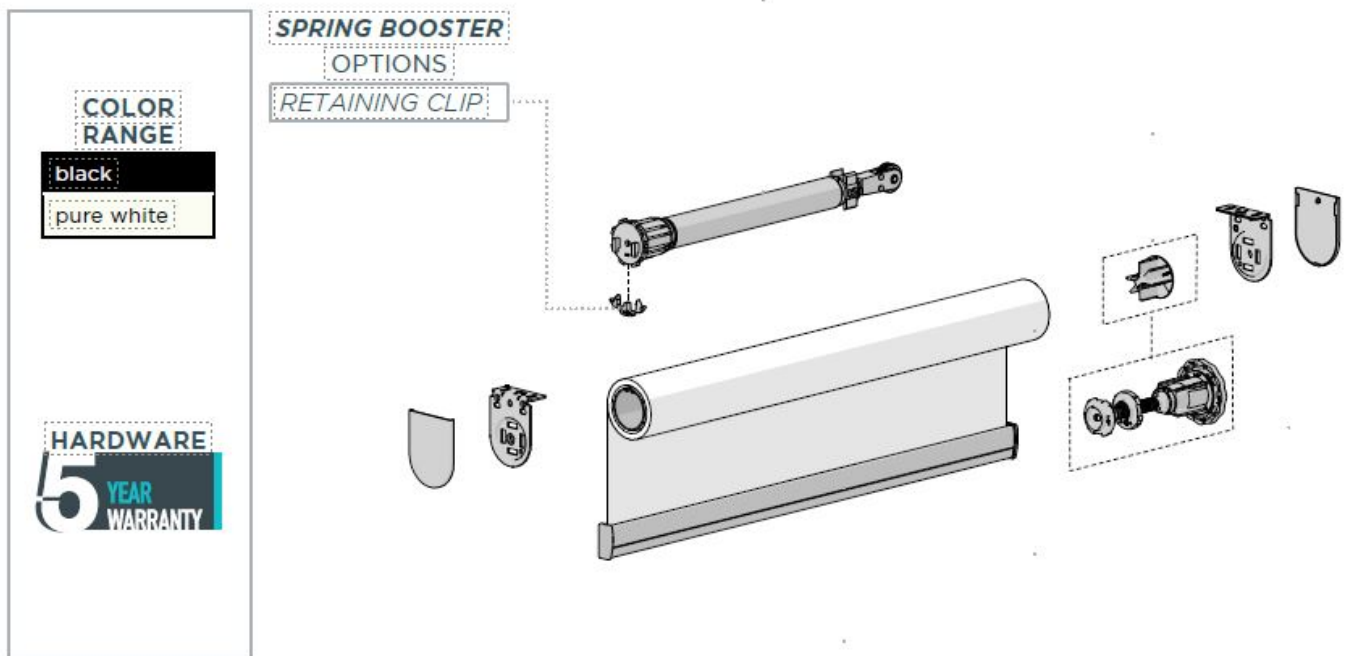

SPRING ROLLER SHADES

Spring roller shade features a heavy-duty spring-assist mechanism for smooth, reliable operation. To ensure structural integrity, we use precision-engineered metal tubes. These shades include universal mounting brackets and a simple cordless pull system at the hembar, allowing you to easily adjust light levels from full sun exposure to complete privacy.

Minimum Width: 15" Minimum Height: 18"
Maximum Width: 97" Maximum Height: 108"



ADJUSTING SPRING TENSION

The tension on the spring of your roller shade is already preset. If you wish or need to make any further adjustment, follow below noted procedures:

A. INCREASE LIFTING POWER

- 1) With the shade in the window, pull the shade part way down
- 2) Remove it from the mounting brackets and roll it half-way
- 3) Replace it in the brackets of the windows and try it for tension and length that it will go down without being over-taught (unable to roll down anymore). Do not force it if it does not want to move downward as it is now over-wound - instead now try decreasing the tension as follows:

B. DECREASE LIFTING POWER

- 1) With the shade in the window, roll the shade all the way up
- 2) Remove it from the mounting brackets and roll it half-way down
- 3) Replace it in the brackets of the windows and try it for proper lift & drop tension and travel distances top to bottom.

Note If the shade will not travel all the way to the top, then the spring tension needs to be increased -follow procedure **A**

If the shade will not travel all the way to the window sill or beyond, then the spring tension needs to be decreased-follow procedure **B**.

HEM BAR OPTIONS

Heat Sealed Hem Bar The standard. A weighted aluminum weight bar is inserted into a 1 1/2" heat sealed pocket. Sealed Ends are the standard default. Open ends available.

Fabric Wrapped Hem Bar Available in Anodized, White and Black. Fully Wrapped, Half Wrapped or Fully Exposed. Handle included for cordless Shades, Optional Pull Hook available for hard to reach shades.

Grommated Hem Bar with Hold Downs for exterior shades which require further security

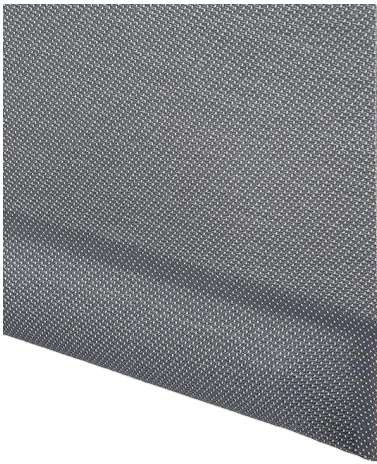

Heat Sealed Hem Bar



Fabric Wrapped Hem Bar



Grommated Hem Bar with Hold Downs

VALANCE OPTIONS

SOFT VALANCE

The soft valance is made out of the same fabric as the roller shade. The fabric valance has both a top and bottom pocket. The top pocket has a piece of wood inserted and the bottom pocket contains the same metal slat in the pocket as the roller shade hem. Screw through the top pocket and wood to mount the soft valance. The standard length is 6".



FASCIA SYSTEM - 3", 4" , 5.5" and 7"

Fascia systems are a decorative aluminum cover compatible with skyline roller shade hardware systems. The system is multi-functional in both mounting and finished appearance.

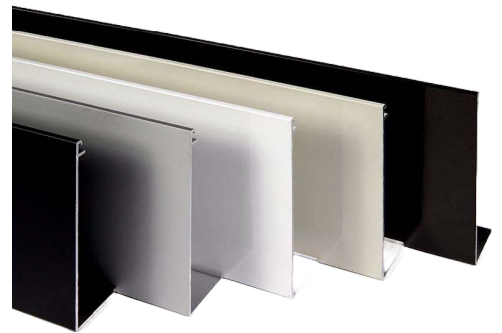

FEATURES

- Compatible with chain & motorized roller shade systems
- Large color range to suit any interior
- Suitable for residential and commercial applications
- Easy to install

COLORS



Bronze
080



White
075



Black
BK



Anodized
020

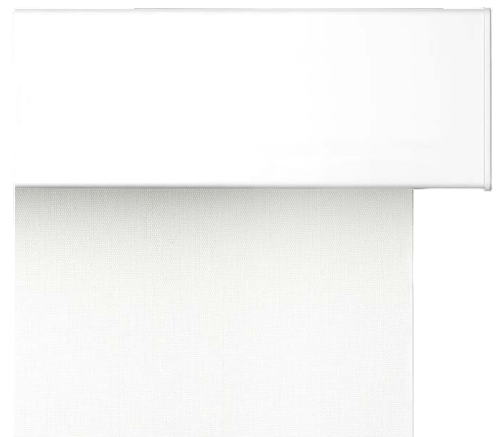

CURVED CASSETTE 100 & 110 SYSTEMS

- Two different headrail sizes
- Sleek, gently curved cassettes that accommodate upscale commercial needs and afford greater residential appeal
- Quick and Easy Installation
- Linking available for two shades in one headrail
- Clutch, cordless & motorized options
- Improved end cap design for ultimate durability



MAX ROLL

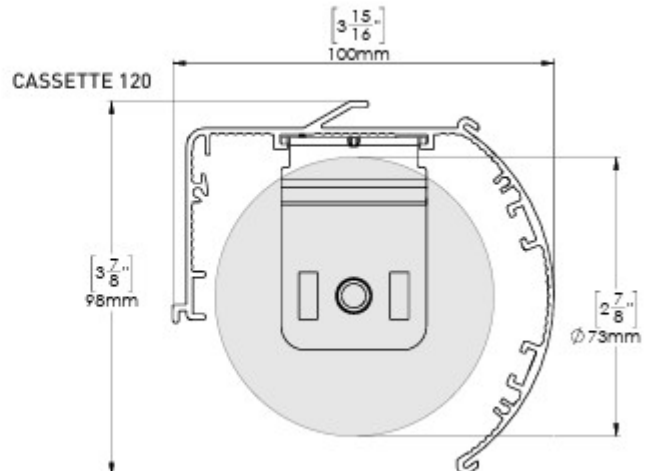
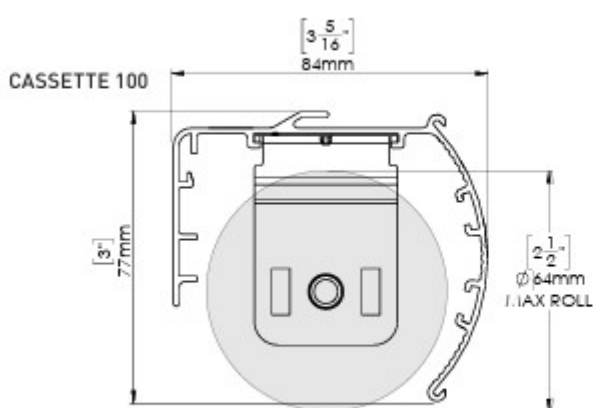

SQUARE CASSETTE 110 SYSTEM

- Sleek, durable one-piece cassette that is just the right size
- Fabric wrap option
- Contemporary appearance
- Quick and easy installation
- Fabric brush feature to help reduce light gap
- Clutch, cordless & motorized options
- Reverse roll compatible

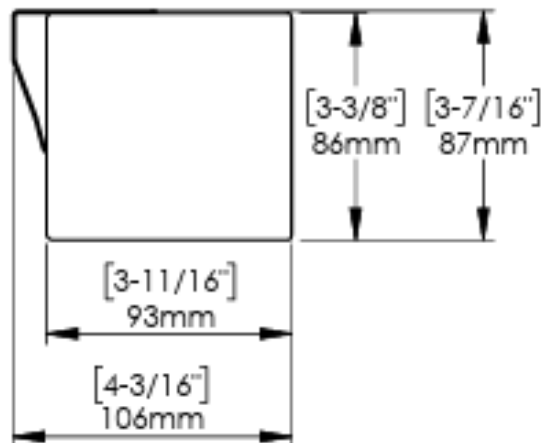

POCKET-CONTRACT

- Recessed shading systems allow shades to seamlessly disappear into any ceiling when not in use
- Removable bottom closures available for single and dual shade systems
- Aluminum composition retains structural integrity while allowing for on-site cutting
- Extrusions are 10' lengths to allow for easier transportation and navigation on job sites
- End plates are rotational and symmetrical for ease of installation
- Available in White & Anodized (4" and 5" only)

4" Pocket
AP-44

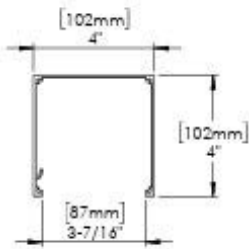

5" Pocket
AP-55

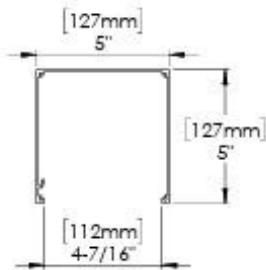

6" Pocket
AP-66

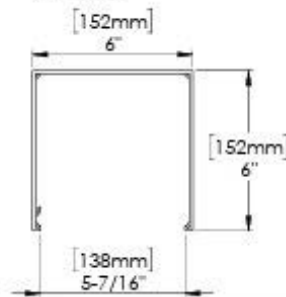

7"x 9" Pocket
AP-79

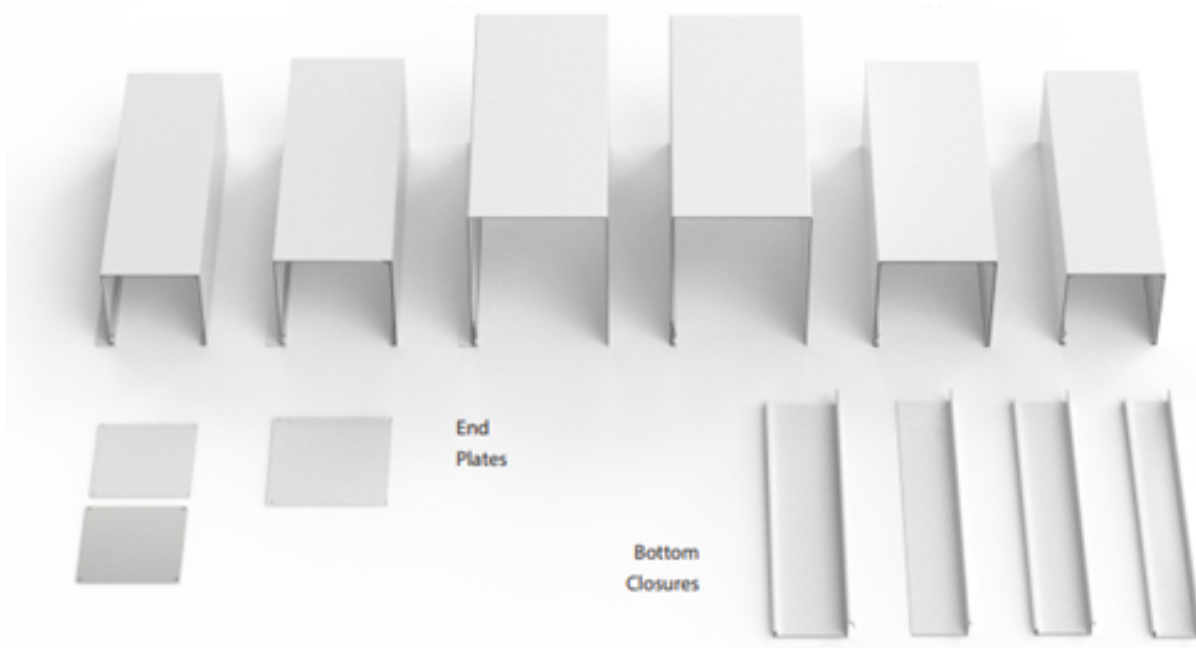
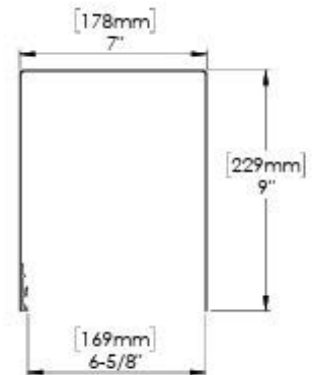

POCKET-CONTRACT

Bottom Closures

2" RETURN: RCCP-8006-075305

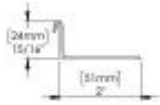

3" RETURN: RCCP-8003-075305

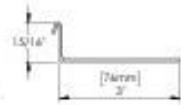

4" RETURN: RCCP-8004-075305

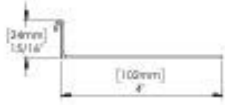

5" RETURN: RCCP-8005-xxx305



4"x 4" Pocket

2" RETURN



5"x 5" Pocket

2" RETURN 3" RETURN

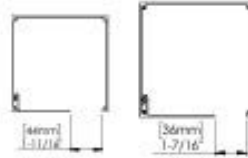

6"x 6" Pocket

2" RETURN 3" RETURN 4" RETURN



7"x 9" Pocket

2" RETURN



3" RETURN



4" RETURN



5" RETURN



Endplates

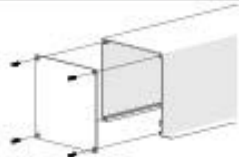

Thickness = 1/16" (2mm)
Endplates sold separately

4": RCCP-4100-xxx000

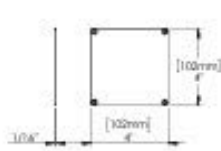

5": RCCP-5100-xxx000

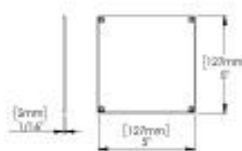

6": RCCP-6100-075000

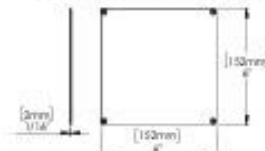

7": RCCP-7100-075000

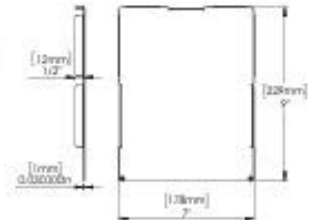

Maximum Roll Diameter

Single Shades

4"x 4" Pocket

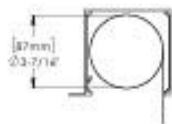

5"x 5" Pocket

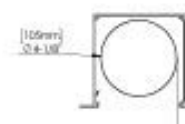

6"x 6" Pocket

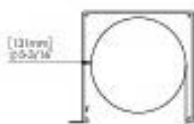

7"x 9" Pocket

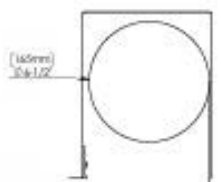

Dual Shades

4"x 4" Pocket

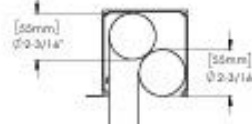

5"x 5" Pocket

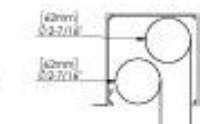

6"x 6" Pocket

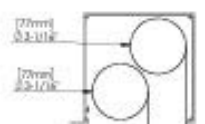

7"x 9" Pocket

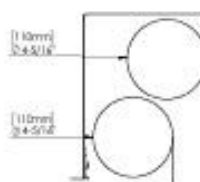

HANGER-CONTRACT

- I Clip Recess Closure-16', White
- Aluminum extrusion designed to conceal the bottom of a roller shade
- I Clip works with multiple return sizes
- Removable return

I Clip Recess Closure

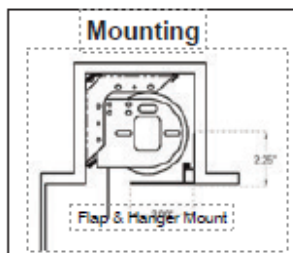
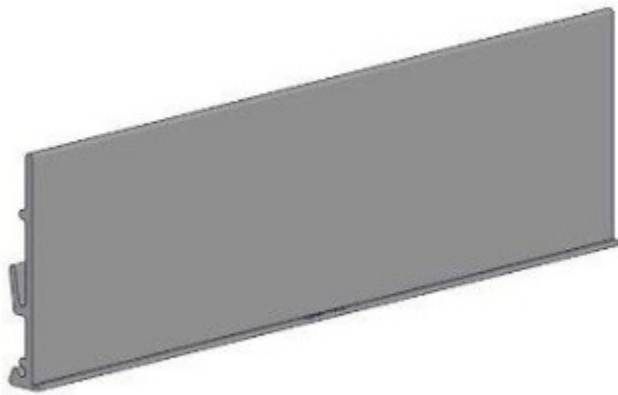

2" RETURN:

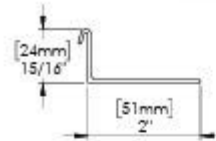

3" RETURN:

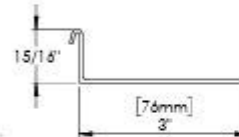

4" RETURN:

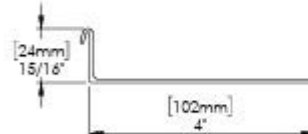

5" RETURN:

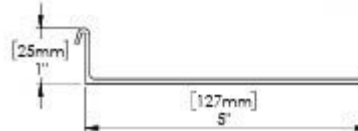

SIDE & SILLCHANNELS

- Aluminum extrusions are used to eliminate light gaps at the left, right & bottom edges of the shade
- Used (primarily) for light control on the side and bottom of the shades
- Side channels are available for both inside and outside mount
- One piece inside mount side channel available in black, bronze, silver & white
- Two piece outside mount side channel available in anodized & white
- End caps available-white & black
- Sill Channel used on the sill to control light bleed at the bottom of the shade

SIDE CHANNELSL

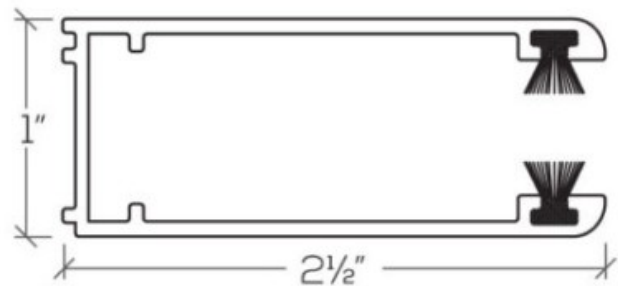

SILLCHANNELSL

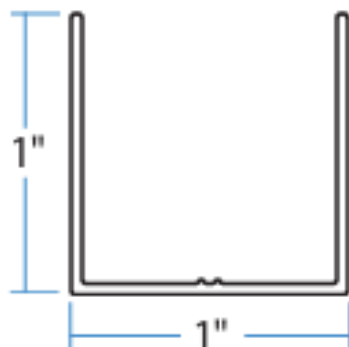

Roller Shade Material

Pristine Roller Shades are available in many colors, textures and privacy options from the top manufacturers in the world.

Pristine Roller Shade Material tend to fall into three categories: Solar Screens, Decorative Transluents & Blackouts. Within these three categories the fabrics range from functional to decorative and everything in between.

Solar Screens

- These are Mesh fabrics designed to control natural light
- Available in many "openness factors" i.e. 1%, 3%, 5%, 10%, etc. Openness Factor affects comfort, the degree of visibility and glare control
- Protects interiors and furnishings from the damaging rays of the sun
- Reduces glare for televisions and computer screens
- Preserves the view to the outside. Note that this view is from the relative dark side to the relative bright side so at night a lit room will be visible from the outside
- Provides a decorative aspect – especially with the latest in Solar Screen designs

Caution!! Some Solar Screen fabrics installed on windows with existing insect screens can cause a "Moiré Effect" which could be objectionable to the end user. It is always best to test for this with a fabric sample BEFORE ordering the shades.

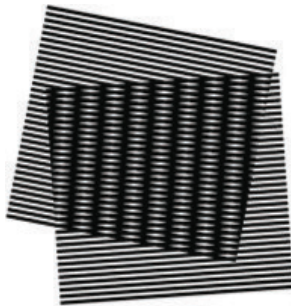

Transluents

- These fabrics let in some light but none of the view affording a nice warm glow in the daytime and privacy anytime
- Pristine has Translucent fabrics that have a matching Blackout counterpart

Blackouts

- As the name implies these fabrics will not allow any direct light to pass through. There is no openness in the fabric, however some portions of the fabric composition are translucent enough that you may see a "glow" behind the shade, particularly if the window is facing east or west. No UV rays penetrate the fabric and there is complete privacy. The "glow" varies by fabric
- Pristine has Blackout fabrics that have a matching Translucent counterpart

Caution: While a Blackout shade does not allow any light to pass through the fabric, light can and will bleed around the sides, top & bottom of the shade. Pristine offers valances, side rails and sill channel to eliminate all light from the window.

MOTORIZED EXTERIOR SCREENS

- Enhance your indoor and outdoor living experience
- Insect screen, solar screen & privacy screen options
- Increase comfort-block heat and harmful UV rays
- Control insects-breezes blow through while bugs & insects stay out
- Improve privacy-relax in comfort without the worry of who's watching



WARRANTY

Porter Preston proudly extends a lifetime-limited warranty on the enclosed product to the original retail purchaser as long as the product remains in the original window.

WARRANTY COVERAGE

Entire product against manufacturing defects (i.e., a flaw in the product design, materials or workmanship that causes the product to no longer function).....Lifetime
 Fabrics.....5 Years
 Somfy/Rollease products.....5 Years

NOT COVERED

Normal wear and tear

Any product that fails due to:

- abuse
- exposure to salt air
- improper installation
- accident
- extraordinary use
- improper operation
- alterations
- improper cleaning
- misapplication
- damage from pets/insects
- improper handling
- misuse

Any product that, with the passage of time, has:

- loss of color intensity

Costs Associated with:

- product removal
- transportation
- brand label removal
- product remeasure
- incidental or consequential damages
- product reinstallation
- shipping

In the event there are multiple shades in the same room, only the defective shade will be replaced. If damage occurred during shipping, call 203-753-1113 and report within 14 calendar days or else you may be denied credit for your damaged product. Any unauthorized returns will not be accepted.

THIS SHALL BE YOUR SOLE REMEDY UNDER THIS LIMITED WARRANTY.

If this product is found to have a manufacturing defect in materials or workmanship, we will

(at our discretion) do one of the following:

- repair the product
- replace the product
- refund the cost of the product
- Colors vary from lot to lot and may not exactly match sample swatch or previous purchases
- Discontinued items or color selections will be replaced with the closest equivalent current product

This lifetime limited warranty gives you specific legal rights and you may have other rights, which vary from state to state. Some states do not allow limitations on how long a warranty lasts so the above limitations may not apply to you. No agent, representative, dealer or unauthorized employee has the authority to increase or alter the obligation of this warranty. This lifetime limited warranty supersedes any previous versions.